

Sheet No. 23
**MAP OF THE
 ABANDONED HOCKING CANAL**

From Sta. 1919+53 to 2010+28.5

Scale 100ft to an Inch.

F. W. Turner Draftsman

Athens and Hocking Counties.

Sheet No. 23

No. 23

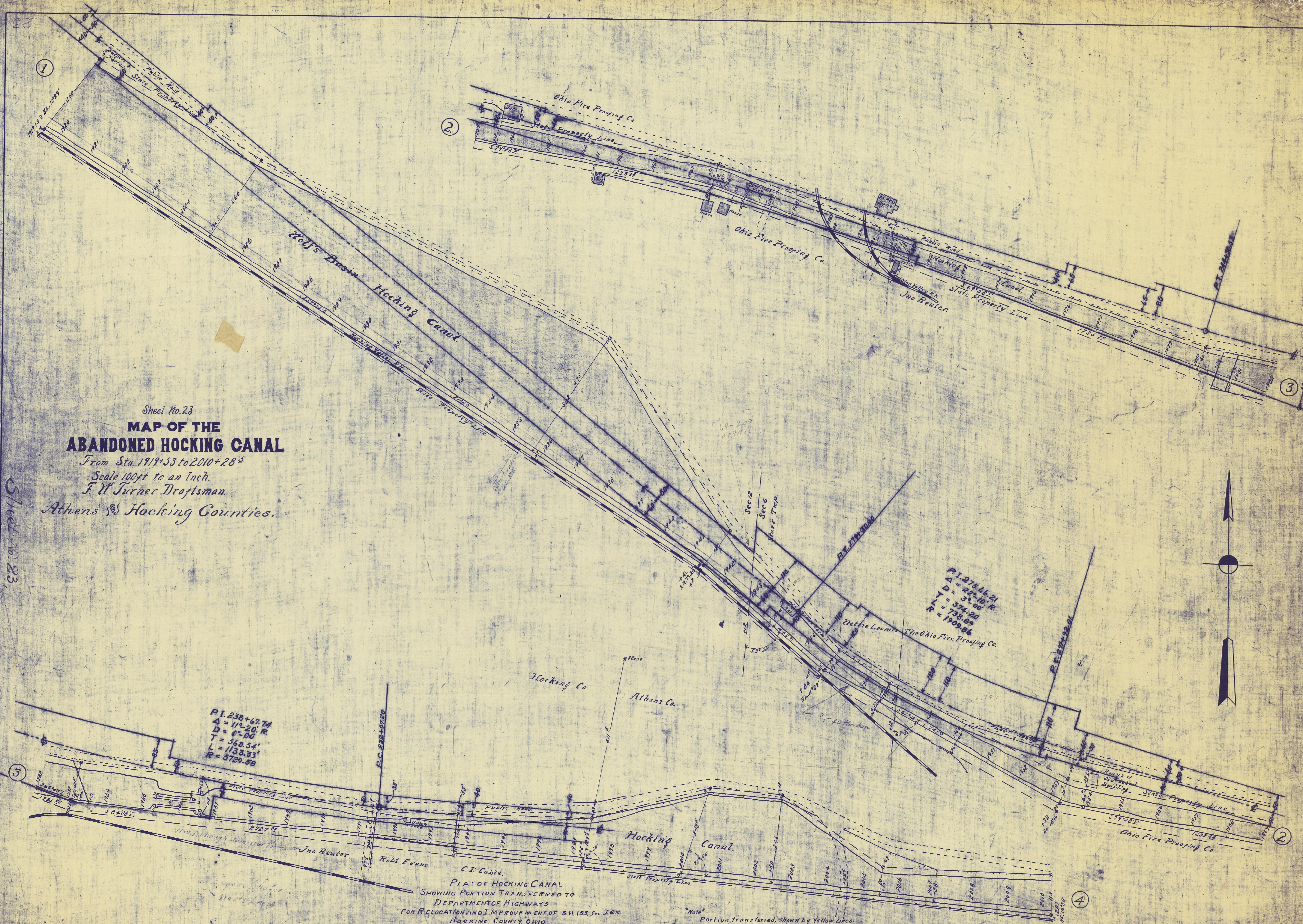

PLAT OF HOCKING CANAL
 SHOWING PORTION TRANSFERRED TO
 DEPARTMENT OF HIGHWAYS
 FOR RELOCATION AND IMPROVEMENT OF S.H. 155, Sec. J & K,
 HOCKING COUNTY, OHIO
 See O.L. 113, Page 521.

Note: Portion transferred, shown by Yellow Lines.

Approved April 1932

Prepared from Sheets 22 and 23 Highway Survey
 By H. E. Whitlock, April 18, 1932.

Director of Public Works.