

Section No 14 Township No 11 Range No 18.

35

Variation
1° 30' N.

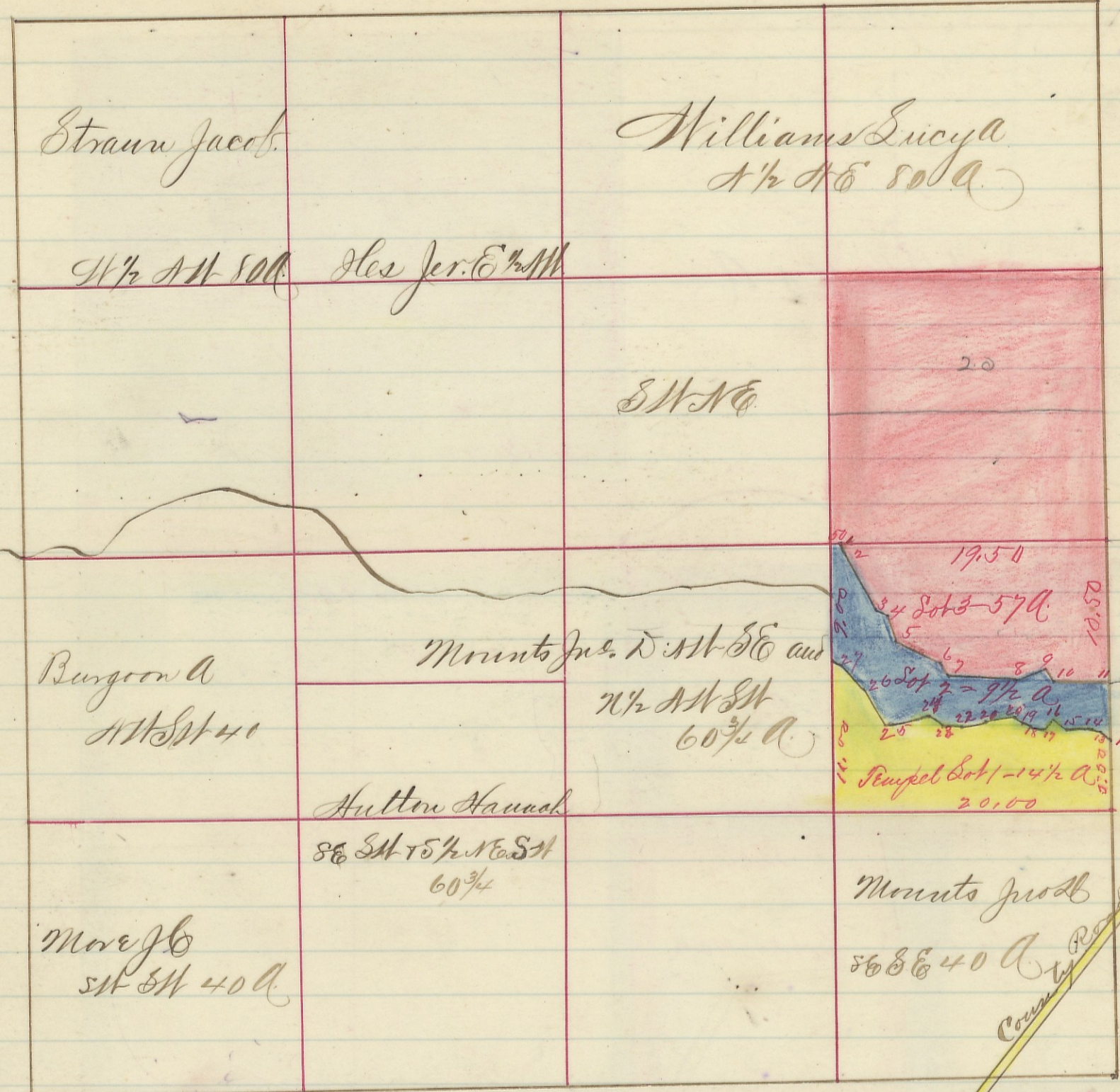

- N 1 S 45° E. 95 ch.
- " 2 S 28 E 4.60 "
- " 3 S 67 1/2 E 8.84 "
- " 4 S 18 E 1.93 "
- " 5 S 61 1/2 E 3.34 "
- " 6 S 31 E .94 "
- " 7 S 83 E 4.90 "
- " 8 N 80 E 2.50 "
- " 9 S 40 E .93 "
- " 10 S 85 E 3.95 " to line
- " 11 South
- " 12 N 45 N 11.00 ch.
- " 13 N 68 N .83 "
- " 14 N 83 N 1.87 "
- " 15 N 58 N 1.13 "
- " 16 S 37 1/2 N .90 "
- " 17 N 81 N 2.00 "
- " 18 N 77 N 2.10 "
- " 19 N 64 N 1.20 "
- " 20 S 87 1/2 N 2.17 "
- " 21 S 77 N 3.60 "
- " 22 N 85 N 1.58 "
- " 23 N 57 N 1.20 "
- " 24 S 82 1/2 N 1.83 "
- " 25 N 32 1/2 N 3.00 "
- " 26 N 50 N 2.74 "
- " 27 N 71 N .83 " to line

I hereby certify the above to be a correct Plat of
 Fractional Lots in Section No 14 Township No 11 Range
 No 18 Hocking County Ohio
 Surveyed 1869 By Levi Davis Surveyor H.C.C.
 Recd. and Recorded Dec 31st 1883.
 Jacob Weaver Recorder H.C.C.