

I.C.H. 155 SEC. K.  
HOCKING COUNTY.

Note: Curve as shown on plan is correct and takes the place of curve now staked on ground.

NATIONAL FIRE-PROOFING CO.

NATIONAL FIRE-PROOFING CO.

NATIONAL FIRE-PROOFING CO.

DATE	BY
SURVEYED	PLOTTED
NOTE BOOK NO.	CHECKS
	PT. OF WAY CHECKED

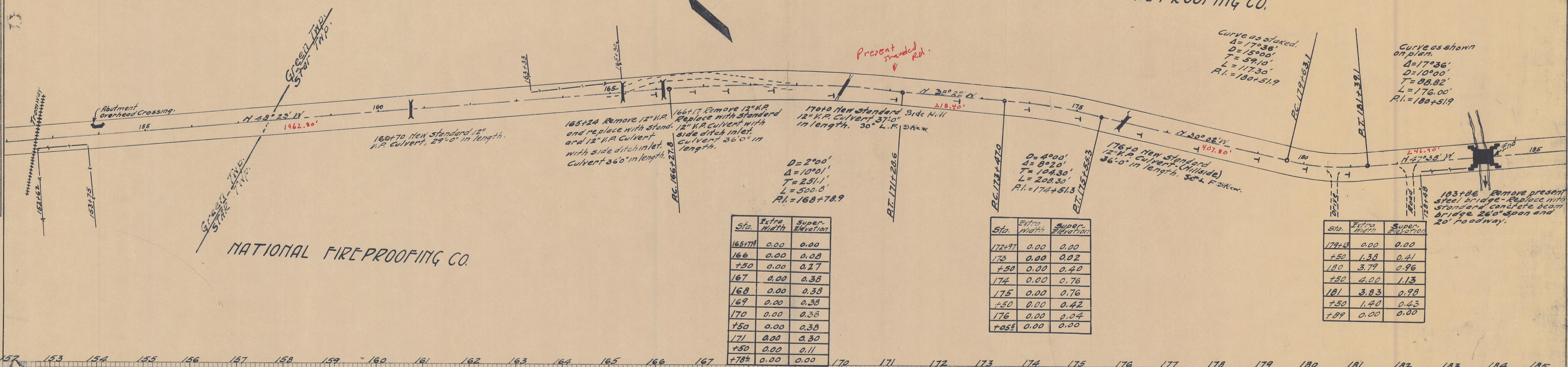

Sta.	Extra Width	Super-Elevation
165+78	0.00	0.00
166	0.00	0.08
+50	0.00	0.27
167	0.00	0.38
168	0.00	0.38
169	0.00	0.38
170	0.00	0.38
+50	0.00	0.38
171	0.00	0.30
+50	0.00	0.11
+78	0.00	0.00

Sta.	Extra Width	Super-Elevation
172+97	0.00	0.00
173	0.00	0.02
+50	0.00	0.40
174	0.00	0.76
175	0.00	0.76
+50	0.00	0.42
176	0.00	0.04
+05	0.00	0.00

Sta.	Extra Width	Super-Elevation
179+15	0.00	0.00
+50	1.38	0.41
180	3.79	0.96
+50	4.00	1.13
181	3.83	0.98
+50	1.40	0.43
+89	0.00	0.00

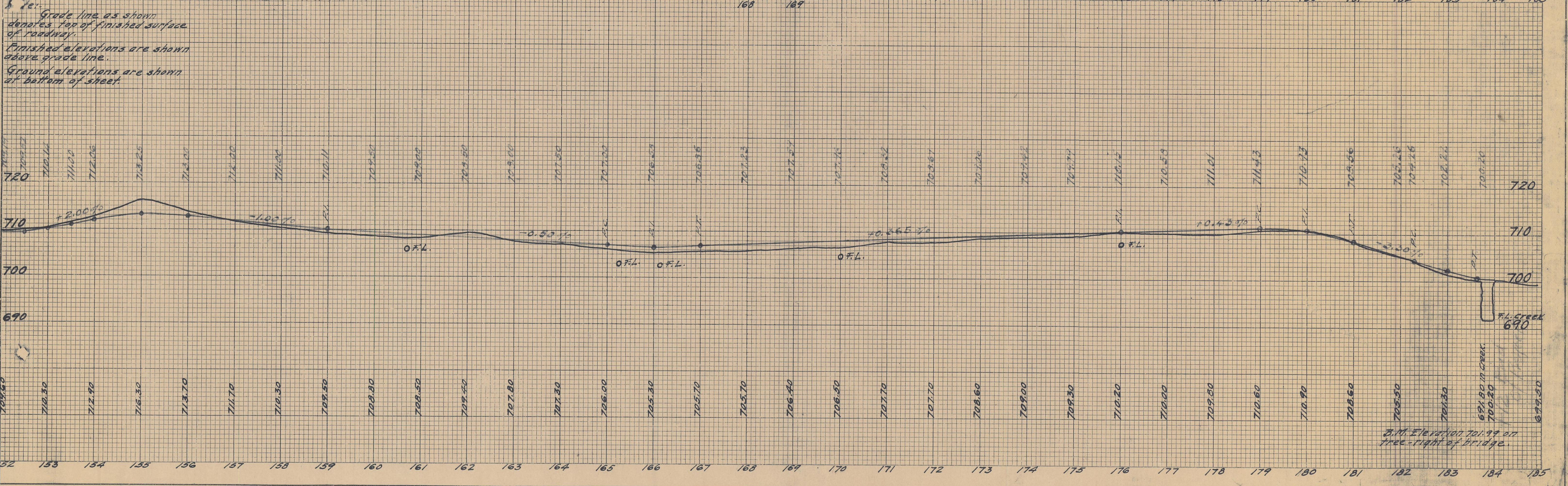

DATE	BY
SURVEYED	PLOTTED
NOTE BOOK NO.	CHECKS
	STRUCTURE NOTATION CH. NO.