

HOCKING COUNTY STATE HIGHWAY 'K'
 PETITION NO. 1649 I.C.H. 360
LANCASTER ~ LOGAN ROAD
 FALLS TWP

Scales: Plan 1"=100'
 Profile 1/4"=100'
 Section 1"=10'
 July 1 1915
 R.W. Bowen Tenn. Engr.

Approved *Orlando C. Brown*
 State Highway Commissioner

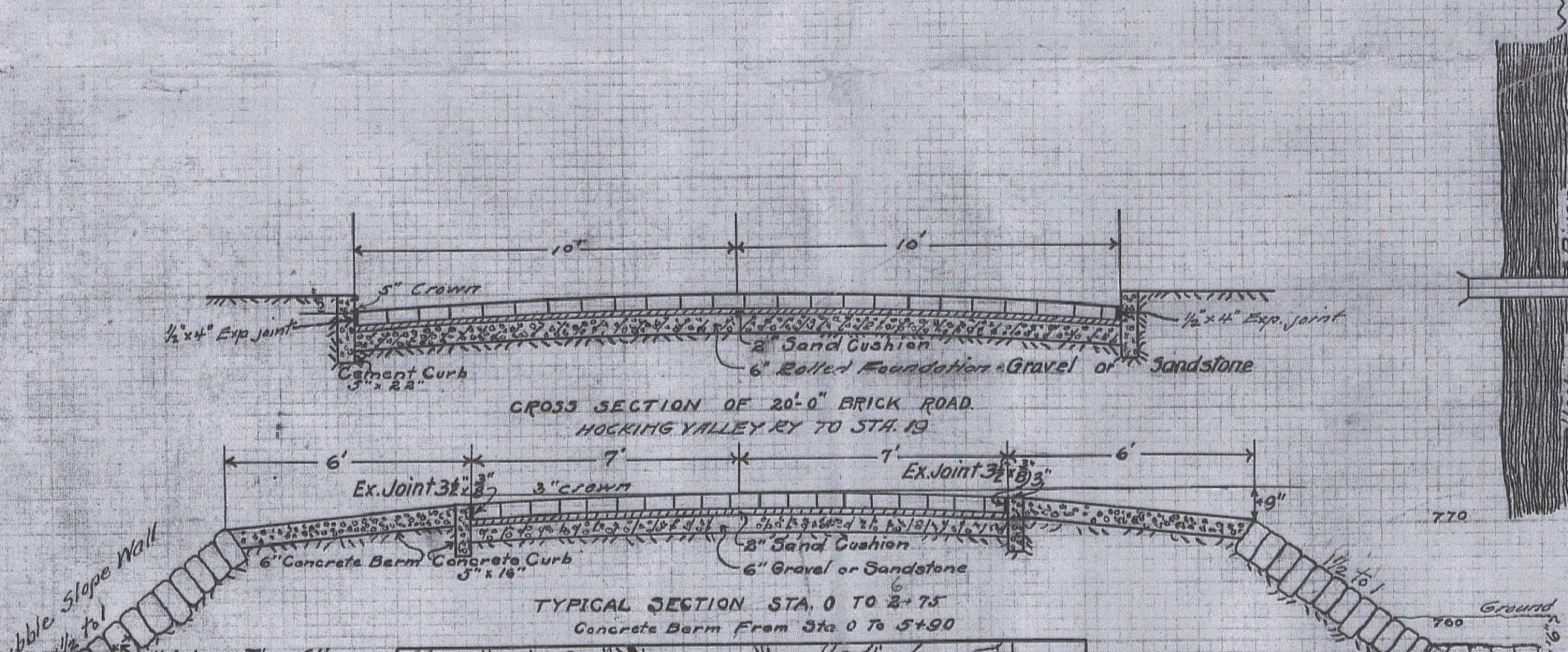
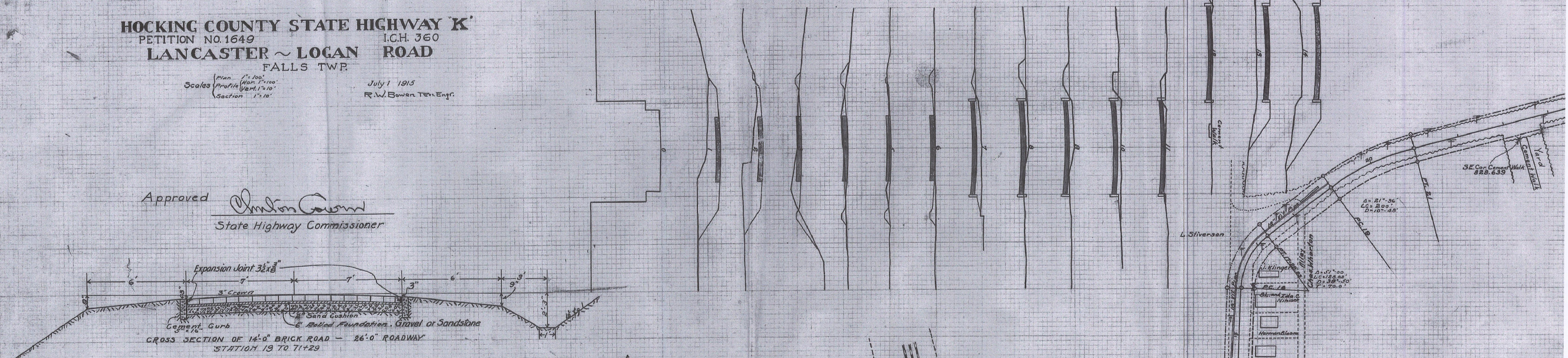

Rubble Slope Wall
 Not Less Than 6"
 Not Less Than 12" and one
 stone to each square yard
 Length longitudinal with slope,
 not less than 12"

SPECIFICATIONS FOR RUBBLE SLOPE WALL
 The stones must be sound, flat bedded stones.
 No round or cobbles stones will be allowed.
 The stones shall be so well bedded and
 fitted as to require neither spalls nor wedges
 to keep them in place.
 The stones shall be laid so that the surface
 will not deviate more than 2" from the
 general plane of the slope.

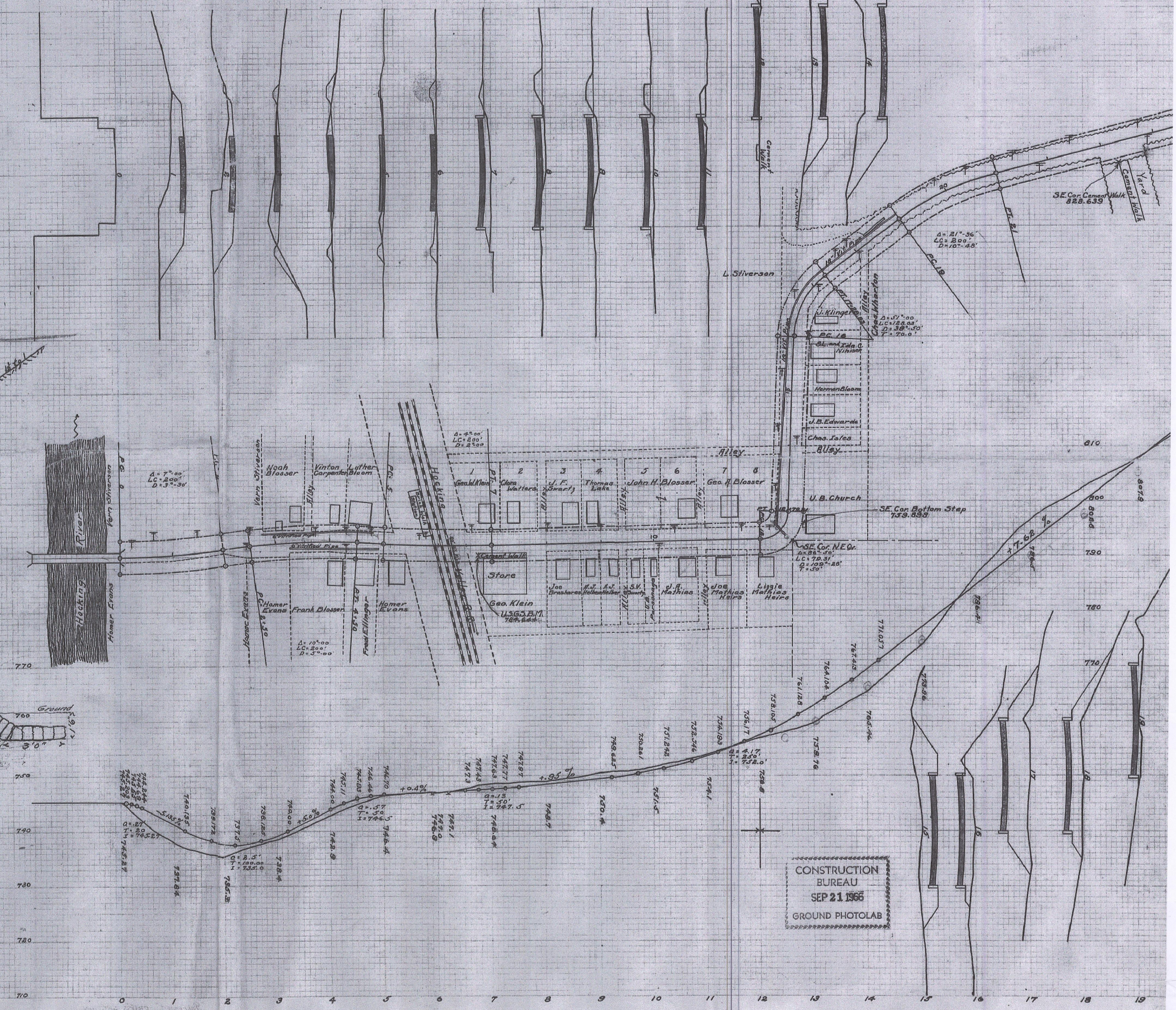
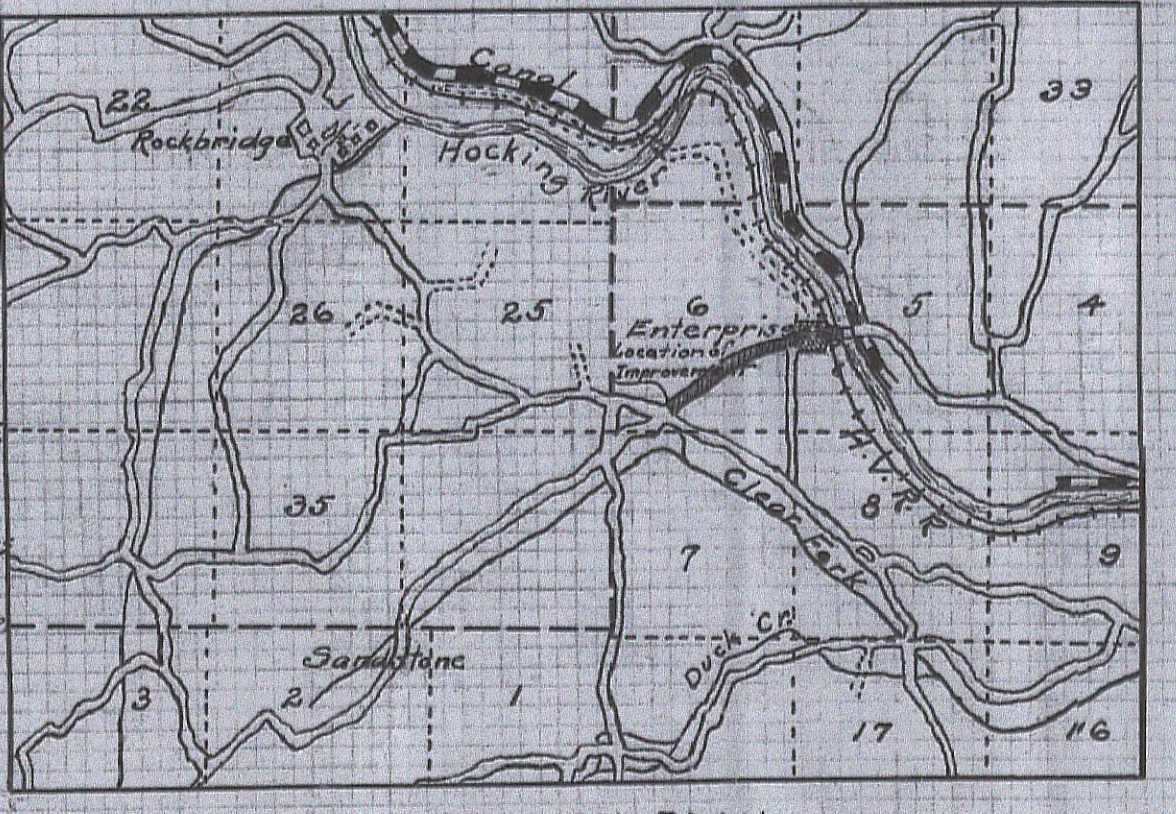

CONSTRUCTION
 BUREAU
 SEP 21 1966
 GROUND PHOTOLAB