

STATE OF OHIO
 DEPARTMENT OF HIGHWAYS

F.A.P. 397-I
 F.A.P. 272 Reloc.
 F.A.P. 397-D Re Un.1

Fed. Aid Dist. No.	State	Fed. Aid Proj. No.	Fiscal Year
10	OHIO	397-I 272 Reloc. 397-D Re. Un.1	1938

S.H. 360 Sec. K (pt), L & D (pt)
 Hocking County

LOGAN-LANCASTER ROAD
 HOCKING COUNTY
 S.H. NO. 360 SEC. K PT, L & D PT.
 FALLS TOWNSHIP

The Standard Specifications of the STATE OF OHIO, Department of Highways, together with "Special Provisions for Federal Aid Projects" and Supplemental Specifications No. E-205, E-208, 73, 47 & 29 (Rev. 7-1-37), in force on date of contract will govern this improvement.

I hereby approve these plans and declare that the making of this improvement will not require that the highway be closed to traffic and that provisions for the maintenance and safety of traffic will be as set forth on the plans and estimates. The right of way necessary for this improvement will be provided by the State of Ohio.

LINE DATA	
Begin F.A.P. 397-I	Sta. 134+00
End F.A.P. 397-I	Sta. 167+86.67
Gross Length of F.A.P. 397-I	3386.67 Lin. Ft.
Additions None	
Deduction Grade Separation	167.76 Lin. Ft.
Sta. 162+27.43 to Sta. 163+95.19	3218.91 Lin. Ft. or 0.6096 Mi.
Net Length of F.A.P. 397-I	
Begin F.A.P. 272 Reloc.	Sta. 167+86.67
End F.A.P. 272 Reloc.	Sta. 254+42.00
Gross Length of F.A.P. 272 Reloc.	8654.63 Lin. Ft.
Additions None	
Deduction None	
Net Length of F.A.P. 272 Reloc.	8654.63 Lin. Ft. or 1.6391 Mi.
Equation of Line	Sta. 254+42.00 of F.A.P. 272 Reloc. = Sta. 254+42.00 of F.A.P. 397-D Re. Un.1
Begin F.A.P. 397-D Re. Un.1	Sta. 254+42.00
End F.A.P. 397-D Re. Un.1	Sta. 283+50
Gross Length of F.A.P. 397-D Re. Un.1	1507.40 Lin. Ft.
Additions None	
Deductions None	
Net Length of F.A.P. 397-D Re. Un.1	1507.40 Lin. Ft. or 0.2854 Mi.
Net Length of Project	13380.94 Lin. Ft. or 2.534 Mi.

CONVENTIONAL SIGNS	
State Line	-----
County Line	-----
Township Line	-----
Section Line	-----
Center Line	-----
Property Line	-----
City or Village Line	-----
Fence Line	-x-x-x-
Pole Line	o o o o o
Steam Railroad	====
Electric Railroad	++++
Guard Rail
Drain Pipe-New	-----
Drain Pipe-Old	-----

INDEX OF SHEETS	
Title Page	Page 1
Typical Section	Page 2-3, 4, A & B
Plan and Profile	Page 5-9
Curve Tables	Page 10-12
Cross Sections	Page 13-19
Private Drives	Page 80-90
Structural Plans	Page 91-109
Summary	Page 110-111-106

NET LENGTH OF PROJECT = 13380.94 LIN. FT OR 2.534 MI.

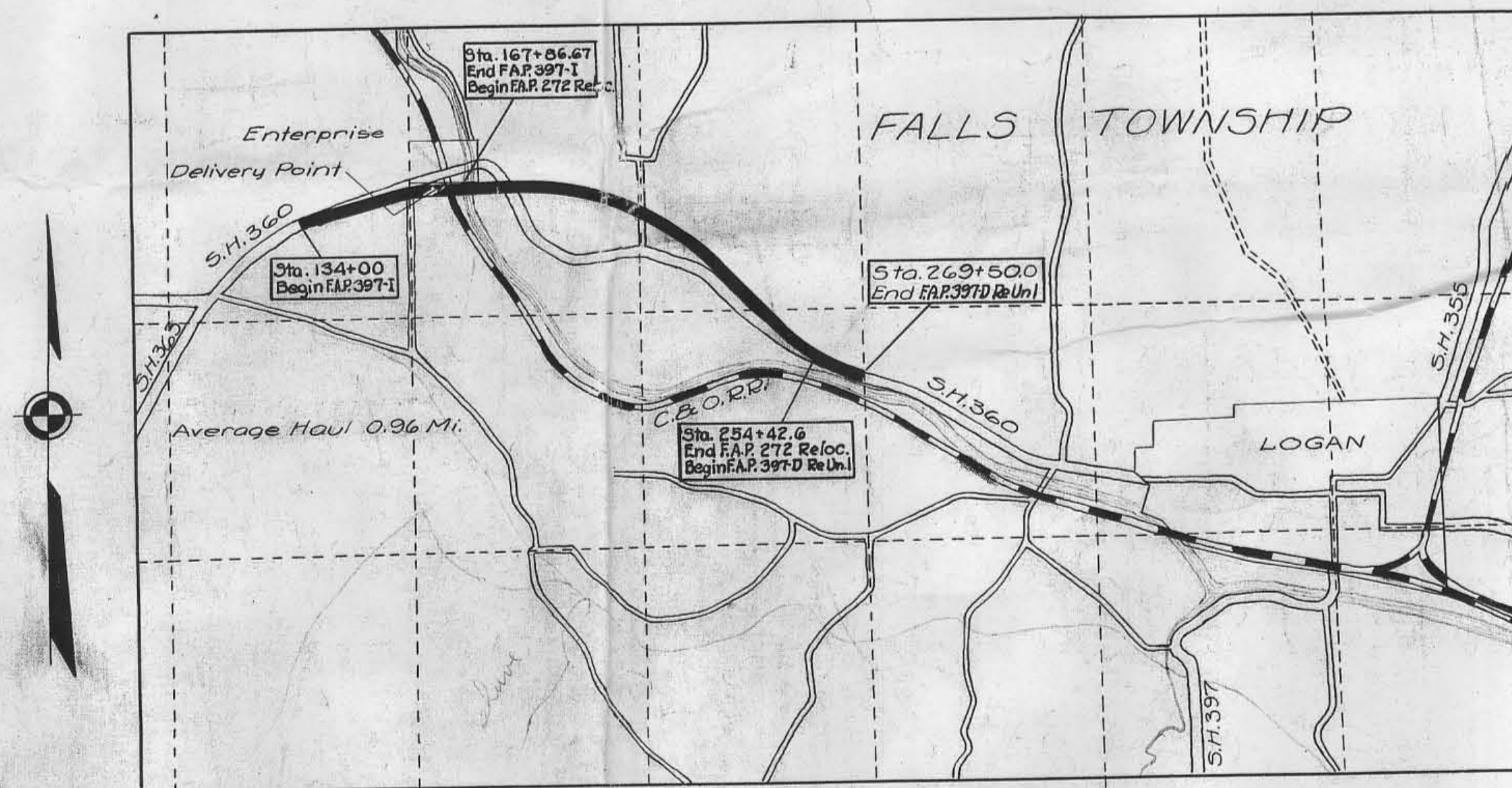

LOCATION PLAN

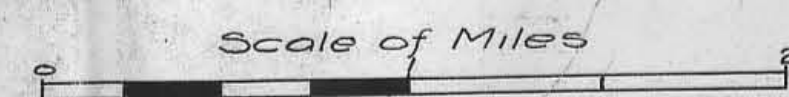

Portion to be improved	====
Detours shown thus	-----
State Highways	=====
Improved County Roads	=====
Unimproved County Roads	-----

SCALES

Plan	1" = 100'
Profile Vertical	1" = 10'
Profile Horizontal	1" = 100'
Cross Sections	1" = 5'



- Approved B. V. Wright P.E. #15
 Date 5/17/37 Resident District Deputy Director
- Approved Harley E. Colvin
 Date 5/17/37 Resident Division Deputy Director
- Approved J. L. Pittman P.E. #83
 Date 7/28/37 Chief Engineer Location & Design
- Approved _____
 Date _____ Chief Engineer Bureau of Maintenance
- Approved B. Burkey P.E. #45
 Date 6-16-37 Chief Engineer Bureau of Bridges
- Approved _____
 Date 7-22-37 First Assistant Director and Chief Engineer
- Approved J. D. Carter
 Date 7-24-37 Director of Highways
- Recommended for Approval _____
 Date _____ District Engineer Bureau of Public Roads
- Recommended for Approval _____
 Date _____ Chief Engineer Bureau of Public Roads
- Approved _____
 Date _____ Chief of Bureau

Supplemental Prints of Standard Construction Drawings	
Drawing No.	Revision
G-107	10-1933
E-5	7-12-35
MED-36	
C-55-35	9-6-35
B-150-701E No. 1	10-1933
B-110-71E No. 1	10-1933
B-71E No. 1	10-1933
T-10-71E No. 1	10-1933
T-9-E No. 1	8-1933
B-771R	6-15-37
T-1, 3, 4 & 5	1-1-36
A5-15	
T-81B1-2&22	11-12-35
T-81B1-3&14	11-12-35
T-1001	4-1-36
T-1002	4-20-36
T-1003	1-1-36
T-1004	11-15-33

File 300

File No.	Hocking 360 & L & D
300	Date of Letting _____
	Contract No. _____