

Existing Structure to (To Be Removed)
HOC-664-0.09
Asphalt & Wood Deck on Steel Beams
Cut Stone and Concrete Abutments
Skew: 5° L.F.
Payment for Structure Removed, See Sheet 13

Proposed Structure
HOC-664-0.09
10' x 4' Conduit, Type A, 706.05. As Per Plan
Alignment: 5°59'02" Curve Rt
Skew: 3°22'38" L.F.

Sta 4+75.20 S.R. 664
Sta. 100+00 Culvert @
Skew; 3°22'38" L.F.
S.L.M. 0.09

P.I. Sta = 5+31.67
D = 10° 25' 06" (RT)
Dc = 5° 59' 02"
R = 957.48'
T = 87.29'
L = 174.10'
E = 3.97'

UTILITY NOTE:
SEE PAGE 3 FOR
UTILITY CONFLICT
INFORMATION

Existing Profile

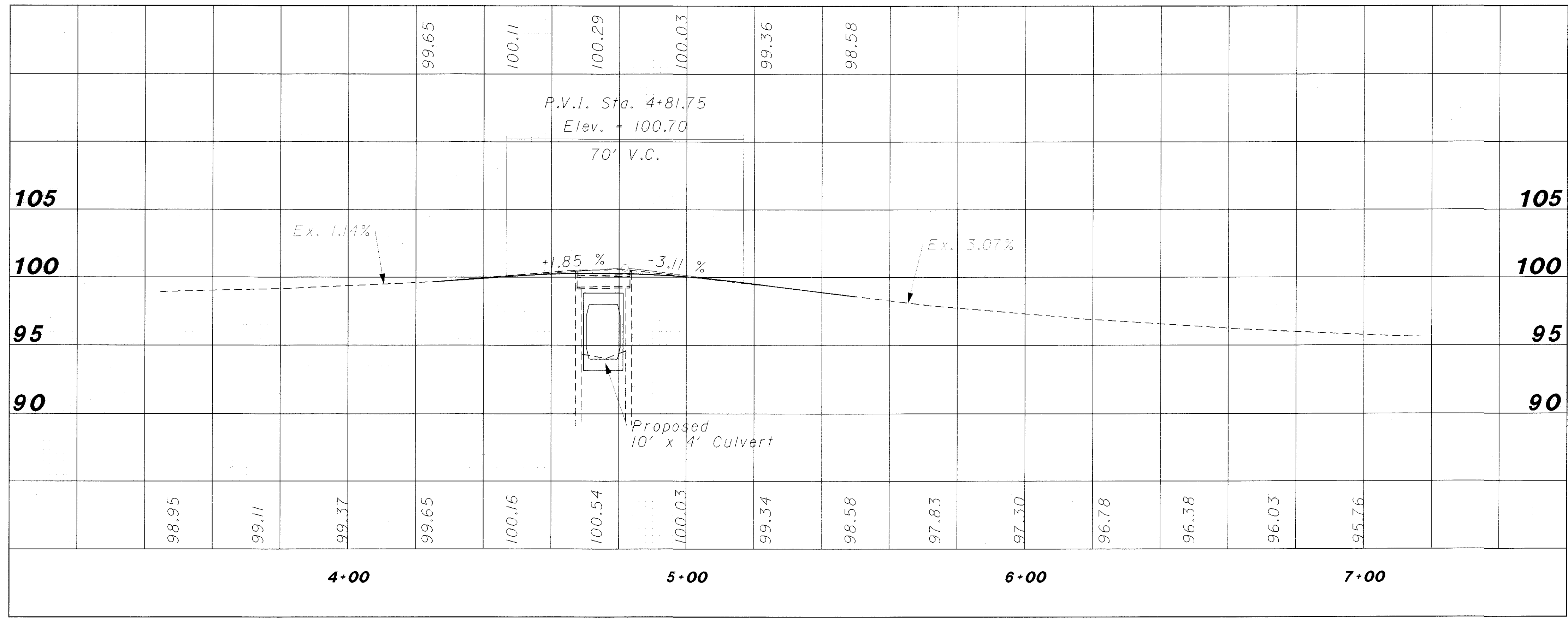

REF NO.	STATION		SIDE	GENERAL SUMMARY	
	FROM	TO			
1-R	4+66.21	4+82.05	RT		
2-R	4+68.33	4+83.16	LT		
1-GR	4+55.41	5+13.79	RT	62.5	3
2-GR	4+63.95	6+39.85	LT	137.5	5
3-R	4+66.20	4+67.71	LT		3
TOTALS CARRIED TO GENERAL SUMMARY				200	8
				25	3

09 JAN-2004 10:39AM gwr\right
D:\proj\tech\hoc664009\Doc\hoc66444\pl.dgn