

CALCULATED BY: *CJD* DATE: 2-19-79  
 CHECKED BY: *MHL* DATE: 2-19-79

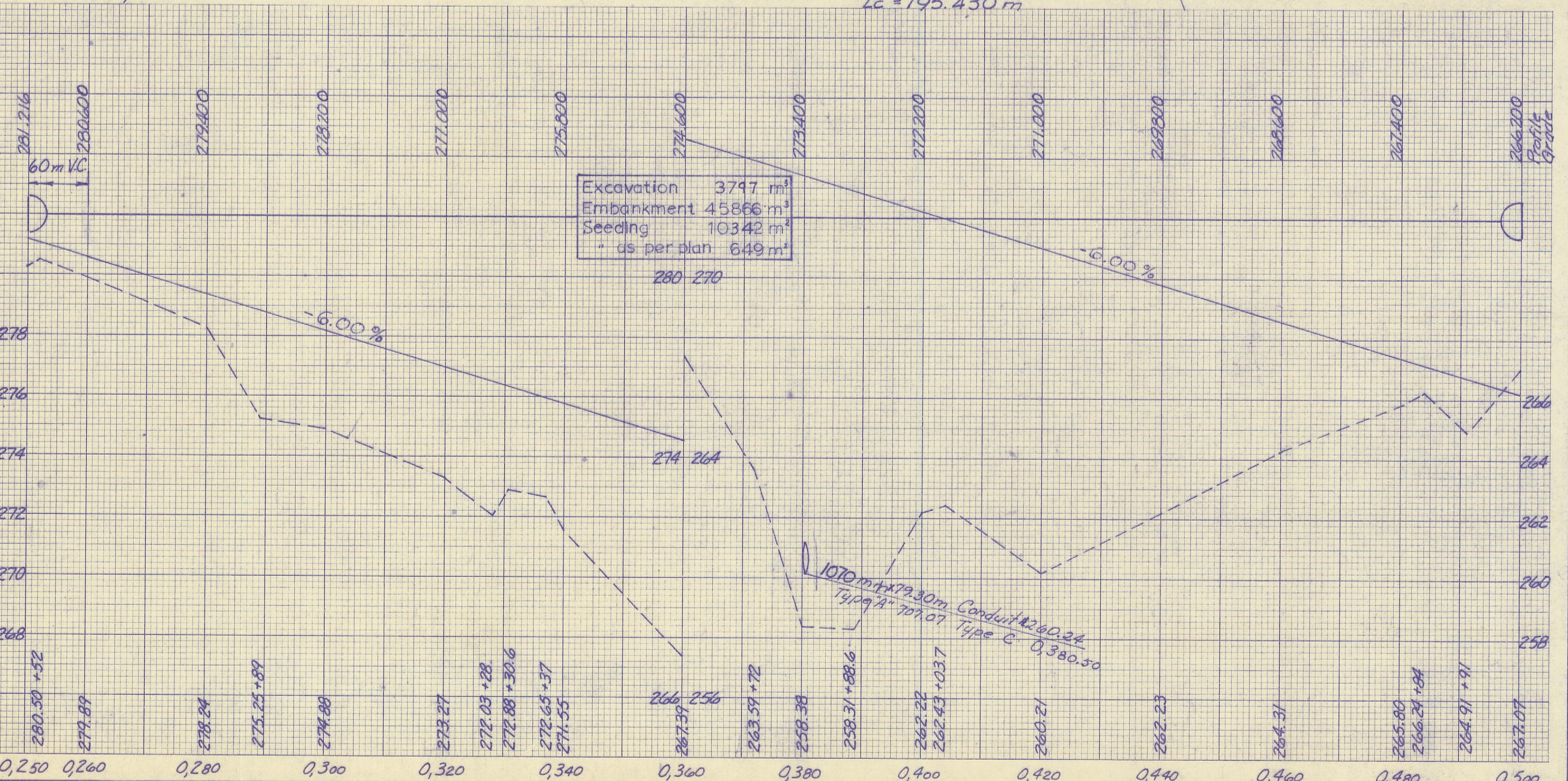
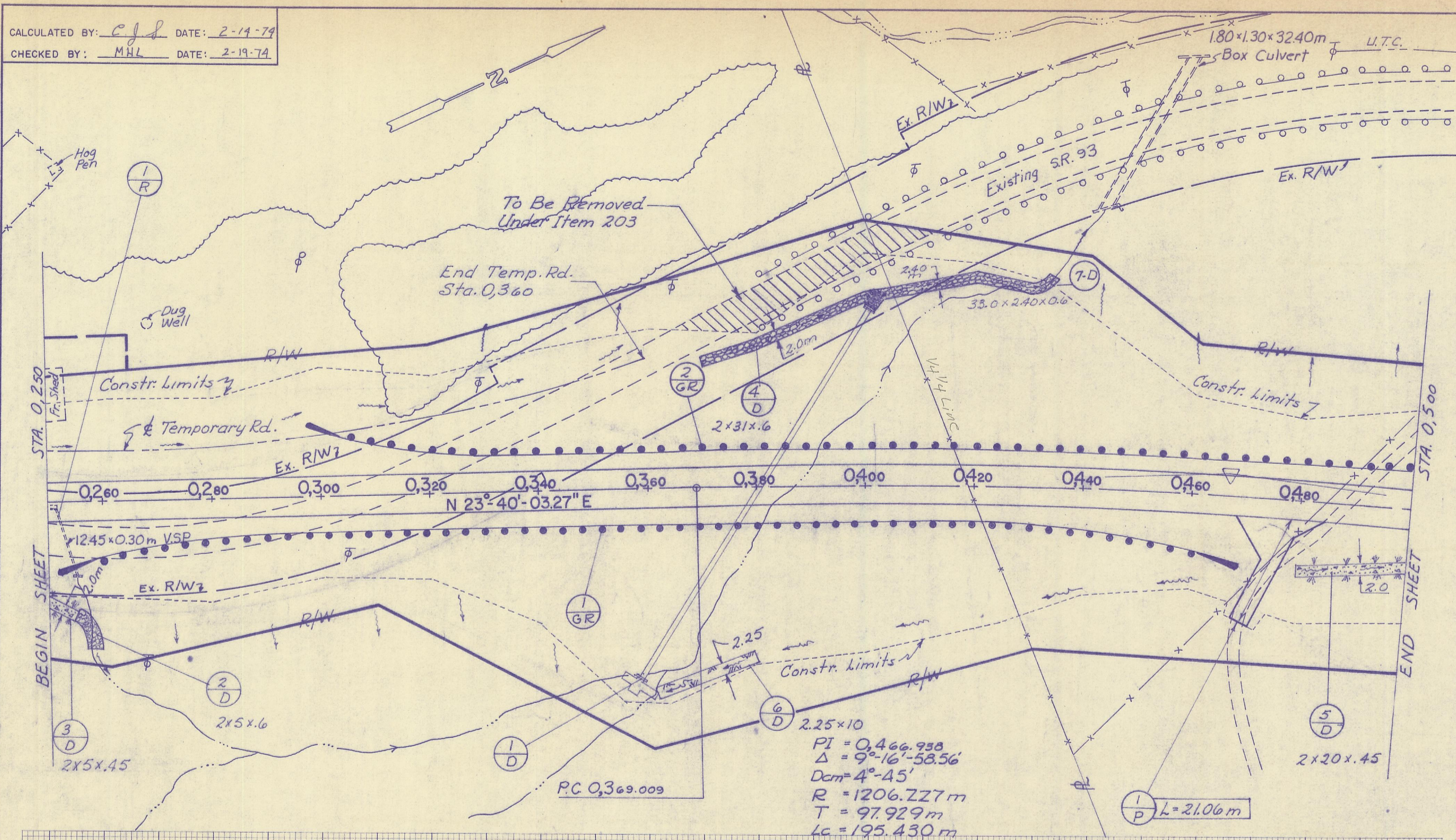

REF. NO.	STATION TO STATION	SIDE	Sec Sheet No.	ESTIMATED QUANTITIES	TOTALS
I-R	ROADWAY 0.251 to 0.255	Rt.			
I-D	0.2524 to 0.469	Rt.			
2-GR	0.298.40 to 0.500	Lt.			
DRAINAGE					
I-D	0.386.50	℄	54		
2-D	0.255 to 0.260	Rt.			
3-D	0.250 to 0.255	Rt.			
4-D	0.370 to 0.401	Lt.			
5-D	0.480 to 0.500	Rt.			
6-D	0.360 to 0.380	Rt.			
7-D	0.403 to 0.434	Lt.			
I-P	PAVEMENT (Fig. Dr.)	Rt.	36		
TOTALS					

PLAN & PROFILE FROM STA. 0.250 TO STA. 0.500