

WILLIAM F. WALKER  
LOGAN, OHIO  
R.R.#6  
10

Pl. 93+82.94  
Δ = 54°-06'L  
D = 1°-45'  
L = 3091.43  
E = 402.17  
R = 3274.17  
T = 1671.94

OTTO & EMMA SHAW  
ROCKBRIDGE, OHIO

Hairs of Otto Shaw  
Paul M. Shaw  
George C. Shaw  
Roxanna Rish  
Logan, Ohio  
4/2/34  
Vol 67, Page 355

WILLIAM F. WALKER  
LOGAN, OHIO  
R.R.#6  
10

4/3/34  
Vol 67, Page 367

REPLACED  
BY HOC 33-000

OTTO & EMMA SHAW  
ROCKBRIDGE, OHIO

Hairs of Otto Shaw  
Paul M. Shaw  
George C. Shaw  
Roxanna Rish  
Logan, Ohio  
4/2/34  
Vol 67, Page 355

TRUSTEES OF FAIRVIEW M.E. CHURCH

C. J. Griffith  
Zach Crawford  
Paul Starnier  
Frank Cookley  
Henry Ringhiser  
Louis Evans  
W.F. Walker  
Rockbridge Ohio  
R.R.#1

REPLACED  
BY HOC 33-001

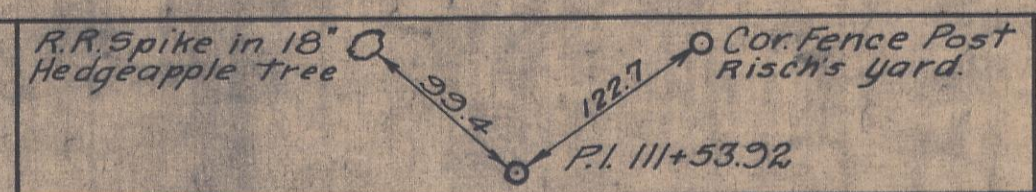

WILLIAM F. WALKER  
LOGAN, OHIO  
R.R.#6  
1915

Pl. 3+16.05  
Δ = 36°-39'L  
D = 30'  
L = 122.17  
E = 10.20  
R = 19.089  
T = 64.00  
PC = 2+152.05  
PT = 3+74.22

Pl. 93+82.94  
Δ = 54°-06'L  
D = 1°-45'  
L = 3091.43  
E = 402.17  
R = 3274.17  
T = 1671.94

Pl. 111+53.92  
Δ = 17°-26'L  
D = 2°-30'  
L = 697.33  
E = 26.78  
R = 2292.01  
T = 351.49

S.C. RISCH  
LOGAN, OHIO  
R.R.#6  
17

4/3/34  
Vol 67, Page 357

FRED EDWARDS  
LOGAN, OHIO  
R.R.#6  
18

4/3/34  
Vol 67, Page 361

Pl. 128+20.33  
Δ = 19°-18'R  
D = 2°-00'  
L = 965.00  
E = 41.11  
R = 2864.79  
T = 467.15

WILLIAM F. WALKER  
LOGAN, OHIO  
R.R.#6  
1915

Pl. 2+43.5  
Δ = 62°-35'R  
D = 20'  
L = 312.92  
E = 48.77  
R = 286.48  
T = 175.04

SAMUEL BLUM  
LOGAN, OHIO  
R.R.#6  
16

4/3/34  
Vol 67, Page 358

JOHN H. BLUM  
LOGAN, OHIO  
R.R.#6  
19

4/3/34  
Vol 67, Page 364