

BRIGHT-OHIO, L.P.

SUBDIVISION

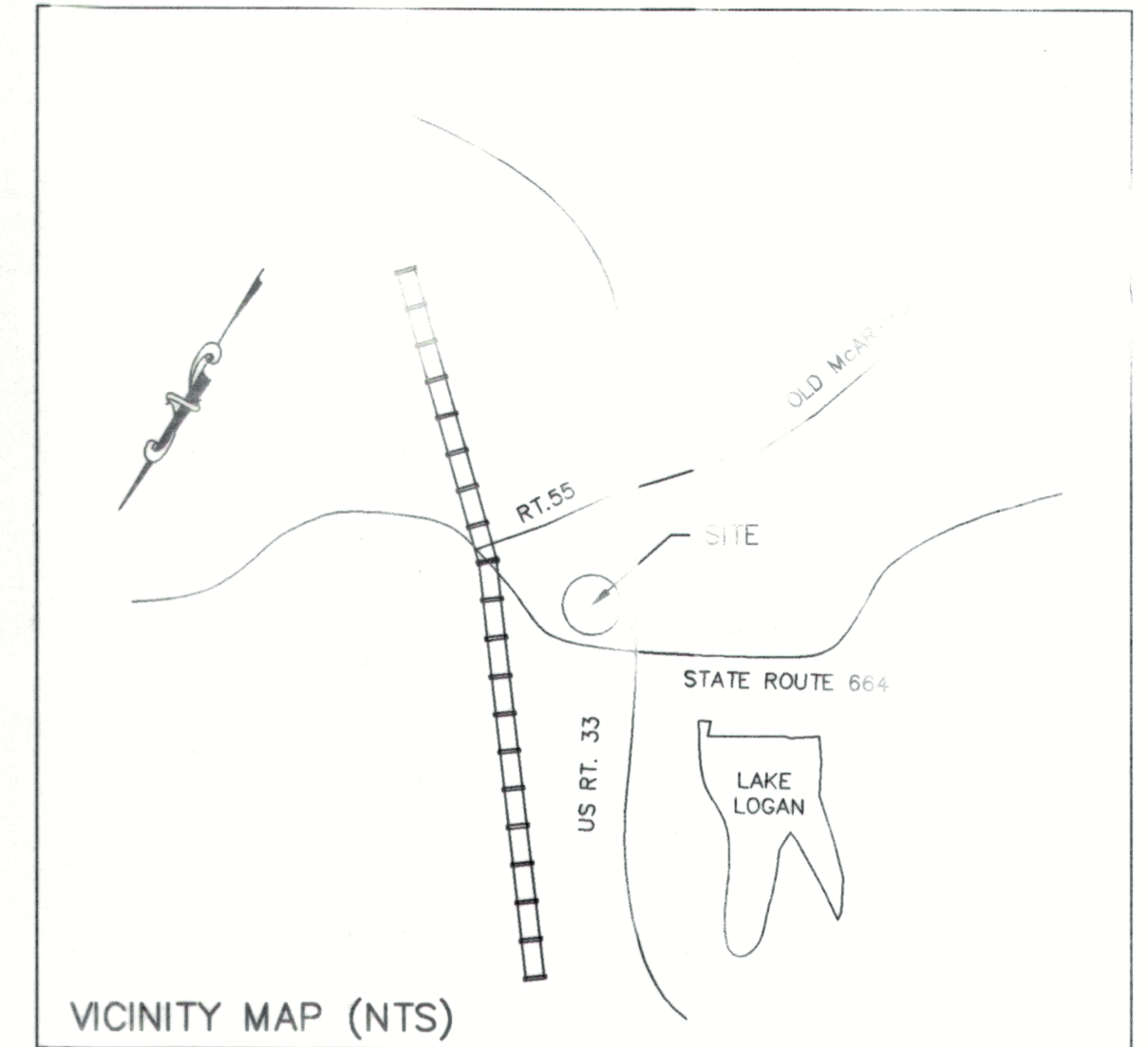

LEGAL DESCRIPTION

TOTAL TRACT
Being located in Falls Township, Hocking County, State of Ohio and being part of the Southern half of Section 10 and the Northern half of Section 15 and being more fully described as follows:

Commencing at an iron pin located at the right of way intersection of the northeastern right of way of US Rte 33 and the southeastern right of way of Ohio Rte 664, said iron pin being the westernmost corner of BEF REIT, Inc. (OR 71-251);

Thence along the northeastern right-of-way of US Rte 33, South 27 degrees 06 minutes 05 seconds East for 304.56 feet to an iron pin, said iron pin being the southernmost corner of BEF REIT, Inc. (OR 71-251) and being the POINT OF BEGINNING;

Thence leaving said right-of-way along the common line of BEF REIT, Inc. North 08 degrees 03 minutes 04 seconds East for 186.28 feet to a ~~perman.~~ monument set;

Thence North 40 degrees 08 minutes 23 seconds East for 214.86 feet to an iron pin found 5/8 inch rebar with cap;

Thence South 49 degrees 49 minutes 19 seconds East for 183.81 feet to an iron pin found 3/4 inch solid;

Thence North 02 degrees 47 minutes 41 seconds East for 66.92 feet to an iron pin found 3/4 inch open top;

Thence North 22 degrees 06 minutes 01 seconds East for 104.88 feet to an iron pin found 3/4 inch solid;

Thence North 23 degrees 58 minutes 09 seconds West for 310.27 feet to an iron pin found 3/4 inch open top on the eastern right-of-way of Ohio Rte 664;

Thence continuing along said right-of-way North 59 degrees 02 minutes 21 seconds East for 169.28 feet to a PK nail found;

Thence North 59 degrees 03 minutes 20 seconds East for 49.96 feet to an iron pin found 3/4 inch open top;

Thence leaving said right-of-way South 39 degrees 11 minutes 41 seconds East for 234.71 feet to a ~~perman.~~ monument set;

Thence North 73 degrees 01 minutes 57 seconds East for 51.38 feet to an iron pin found 5/8 inch rebar;

Thence North 36 degrees 38 minutes 22 seconds West for 149.33 feet to an iron pin found 5/8 inch solid;

Thence North 48 degrees 59 minutes 22 seconds East for 14.80 feet to an iron pin set;

Thence South 35 degrees 45 minutes 00 seconds East for 149.13 feet to an iron pin found 5/8 inch bolt;

Thence North 83 degrees 27 minutes 59 seconds East for 28.97 feet to an iron pin found 5/8 inch solid;

Thence along the common line of Sharp North 67 degrees 08 minutes 10 seconds East for 49.40 feet to an iron pin found 1 inch open top;

Thence along the common line of Conrad North 67 degrees 53 minutes 05 seconds East for 49.25 feet to an iron pin found 5/8 inch rebar;

Thence along the common line of Mohler North 62 degrees 08 minutes 29 seconds East for 25.03 feet to an iron pin set;

Thence North 62 degrees 08 minutes 28 seconds East for 75.83 feet to an axle found;

Thence along the common line of Gable North 64 degrees 00 minutes 02 seconds East for 50.31 feet to an axle found;

Thence along the common line of Schrader North 61 degrees 46 minutes 55 seconds East for 49.70 feet to an iron pin set;

Thence North 65 degrees 28 minutes 38 seconds East for 100.23 feet to an axle found;

Thence along the common line of Fabes North 70 degrees 34 minutes 38 seconds East for 50.03 feet to an iron pin set;

Thence North 74 degrees 25 minutes 10 seconds East for 72.03 feet to an axle found;

Thence along the common line of Fox South 86 degrees 10 minutes 55 seconds East for 65.98 feet to a 3/4 axle found;

Thence South 84 degrees 23 minutes 25 seconds East for 70.18 feet to an iron pin found 5/8 inch rebar;

Thence North 89 degrees 03 minutes 41 seconds East for 74.87 feet to an iron pin found 5/8 inch rebar;

Thence South 76 degrees 08 minutes 50 seconds East for 75.17 feet to an iron pin found 5/8 inch rebar;

Thence South 76 degrees 06 minutes 06 seconds East for 75.16 feet to an iron pin found 5/8 inch rebar;

Thence South 68 degrees 11 minutes 11 seconds East for 86.41 feet to an iron pin found 5/8 inch rebar;

Thence South 71 degrees 07 minutes 55 seconds East for 99.88 feet to an iron pin found 5/8 inch rebar;

Thence along the common line of Maynard South 70 degrees 56 minutes 14 seconds East for 105.40 feet to an iron pin found 5/8 inch rebar;

Thence South 03 degrees 19 minutes 31 seconds West for 164.79 feet to an iron pin set;

Thence along the common line of Bacus South 65 degrees 06 minutes 32 seconds West for 338.92 feet to a ~~perman.~~ monument set;

Thence South 10 degrees 06 minutes 00 seconds West for 106.77 feet to an iron pin found 5/8 inch open top;

Thence South 08 degrees 52 minutes 56 seconds West for 868.59 feet to an iron pin set;

Thence along the common line of property of the State of Ohio South 61 degrees 46 minutes 43 seconds West for 152.07 feet to an iron pin found 5 inch rebar with cap;

Thence along the common line of Huber South 42 degrees 45 minutes 55 seconds West for 210.59 feet to an iron pin set;

Thence South 02 degrees 34 minutes 50 seconds East for 247.07 feet to a ~~perman.~~ monument set on the northeastern right-of-way of Ohio Rte 33;

Thence along said eastern right-of-way North 57 degrees 43 minutes 18 seconds West for 353.19 feet to an iron pin set;

Thence North 39 degrees 59 minutes 37 seconds West for 943.39 feet to an iron pin found 3/4 inch open top;

Thence North 40 degrees 00 minutes 14 seconds West for 174.95 feet to an iron pin found 3/4 inch open top and being the Point of Beginning;

Said tract contains 41.590 acres or 311,661 square feet more or less.

All iron pin sets are 5/8 inch x 30 inch long rebar with plastic ID cap inscribed "MJ Blasio 7389"

All ~~perman.~~ monument sets are Bersten A 2BR30 break-off monument 2 3/8 inch x 33 1/2 inch with 3 1/2 inch aluminum cap stamped "MJ Blasio 7389"

DECLARATION OF PRIVATE OWNERSHIP:

TO BE RECORDED ALONG WITH
SUBDIVISION PLAT, RECORDED IN OR 100 P. 66

OWNERS STATEMENT:

OWNER: Bright-Ohio, L.P., a Tennessee limited partnership, 537 Market Street, Suite 400, Chattanooga, Tennessee 37402
DEVELOPER: Same
SURVEYOR: Freeland & Associates, Inc., 323 West Stone Avenue, Greenville, South Carolina 29609

STATEMENTS: Situated in the State of Ohio, County of Hocking, City of Logan, Township of Falls, being a part of Fractional Lots 1, 2, 3, 6, 7 & 12 in Section 10 & 15, T-14-N, R-17-W, and being all of the tract of land in the name of Bright-Ohio, L.P., as recorded in Official Record Book 179, Page 922; Official Record Book 177, Page 885; Official Record Book 179, Page 920; Official Record Book 179, Page 918; Official Record Book 179, Page 926; Official Record Book 179, Page 930; Official Record Book 179, Page 938; and Official Record Book 179, Page 934.

The undersigned, William M. Henderson, Jr., Vice President of Bright-Ohio, Inc., General Partner of Bright-Ohio, L.P., a Tennessee limited partnership, does hereby certify that the attached plat correctly represents "Bright - Ohio, L.P." a subdivision of Lots 1 thru 7 and does hereby accept this plat of same and dedicate to public use all roads and utilities shown hereon and not heretofore dedicated.

In witness whereof, William M. Henderson, Jr., hereunto set his hand this 20 day of February, 2001.

William M. Henderson, Jr.
William M. Henderson, Jr.

Hamilton
Witness

Before me, a Notary Public, in and for said county, personally came William M. Henderson, Jr., Vice President of Bright-Ohio, Inc., general partner of Bright-Ohio, L.P., a Tennessee limited partnership, who acknowledged the signing of the foregoing instrument to be his voluntary act and deed.

In witness whereof, I have hereunto set my hand and affixed my official seal this 20th day of February, 2001.

Hamilton
Notary Public
My Commission Expires: 9-8-2001
AT LARGE
County

GENERAL NOTES:

- This site to be developed under "B-2" zoning regulations. All lots depicted hereon are to be used for retail business only.
- The bearing system for this plat as based on evidence found on the west line of Bacus Property as described in OR 196, p. 434, and bears S 08-52-56 W.
- Utility easements are reserved around all perimeter lines of the subdivision and either side of all common lot lines and shall be 6' in width.
- Front yard minimum building setbacks is to be 50', side yard minimum building setback is to be 20', rear yard minimum building setback is to be 25'.
- Sanitary & water taps will be installed by the Developer/Owner in accordance with sound construction procedures and are subject to approval of the Local City Service Directors Office.
- The developer insures that electrical & telephone service will be provided in the subdivision.

SURVEYOR'S STATEMENT

I hereby certify that an actual survey was made under my direct supervision of the premises shown hereon on the 25th day of March, 2000, and that said plat is a correct representation of the premises as determined by said survey and that all monuments shown hereon will be set upon completion of site work as shown hereon. I further certify that there are no encroachments either way across any boundary line of the premises except as shown hereon.

Michael J. Blasio
Michael J. Blasio, Registered Surveyor No. 7389
Freeland and Associates, Inc.

SEQUENCE OF CONSTRUCTION PHASE I

- STAGE I
- NOTIFY THE CONCERNING AUTHORITY AT LEAST 48 HOURS PRIOR TO START OF WORK.
 - CLEAR AND GRUB THE AREA WHERE SEDIMENT EROSION CONTROL MEASURES ARE TO BE INSTALLED. (2 DAYS)
 - INSTALL CONSTRUCTION ENTRANCE AND OTHER SEDIMENT CONTROL MEASURES AS SHOWN ON PLAN. (3 DAYS)
 - CONSTRUCT SWM POND/BASIN WITH REEF, PRINCIPAL SPILLWAY, COKE TRENCH AND OTHER APPURTENANCES ASSOCIATED WITH SWM POND AS PER SWM POND PLAN AND DETAIL. KEEP THE GATE VALVE TO 2" POND DRAIN PIPE OPEN. (10 DAYS)
- STAGE II
- CONSTRUCT AND INSTALL DIVERSION 'A' AND DIVERSION 'B'. DIRECT ALL THE DRAINAGE AREA ABOVE DIVERSION 'A' AND 'B' TO BASIN. MAKE SURE THERE IS POSITIVE DRAINAGE TOWARDS BASIN. NOTE THAT SOME FILLINGS ARE NEEDED AT SOME DEPRESSIONS TO HAVE POSITIVE FLOW TO BASIN. (3 DAYS)
 - CONSTRUCT THE TRAP #1 AND INSTALL REMAINING DIVERSIONS. (3 DAYS)
 - ROUGH GRADE THE ENTIRE AREA. CONSTRUCT THE BUILDING PAD AREA BETWEEN DIVERSION 'A' AND 'B' AS FAR AS POSSIBLE WITHOUT DISTURBING DIVERSION 'B'. SIMILARLY ROUGH GRADE THE AREA BELOW DIVERSION 'B' AS FAR AS POSSIBLE WITHOUT DISTURBING DIVERSION 'B'. DIVERSION 'A' COULD BE REMOVED ANY TIME AFTER THE ROUGH GRADING OF THE AREA ABOVE IT. (5 MONTHS)
 - INSTALL THE STORM DRAIN SYSTEM EXCEPT 24-25. PROVIDE AND INSTALL A TEMPORARY PIPE TO TRAP FROM STRUCTURE NO. 22. (1 MONTH)
- NOTE THAT GRADING ALONG SOME PORTION OF THE STORM DRAIN SYSTEM 5-7 WILL BE WELL BELOW THE PROPOSED FINISHED GRADE AT THIS STAGE. THE TOP OF THE STRUCTURE NO. 6 WILL BE WELL ABOVE THE GRADE AT THIS TIME.
- INSTALL INLET PROTECTIONS ON ALL INLETS EXCEPT STRUCTURE NO. 6. DIRECT THE RUNOFF TO BASIN AND TRAP THRU NEWLY INSTALLED STORM DRAIN SYSTEM. (3 DAYS)
- STAGE III
- REMOVE THE DIVERSION 'B' AND COMPLETE GRADING THE BUILDING PAD. GRADE THE AREA ABOVE THE TRAP AS FAR AS POSSIBLE WITHOUT REMOVING THE TRAP. (3 DAYS)
 - VEGETATIVELY STABILIZE ALL THE DISTURBED AREAS. (10 DAYS)

APPROVALS:

Mathematically approved this 23rd day of Feb., 2001

By: *Andi P. Wyle*
Hocking County Engineer's Office

Approved this 23rd day of February, 2001

By: *Aene Phillips, RS*
Hocking County Sanitation

Approved this 20th day of February, 2001

By: *Don R. Halls*
Chairman, Logan City Planning Commission

Transferred on tax duplicate this 28th day of February, 2001

By: *Kenneth R. Wilson*
Hocking County Auditor

Filed for record this 28 day of February, 2001, at 1:05 P.M.

Recorded this 28 day of February, 2001, in Plat Cabinet 2 at page 63, 64, 65, 66, 67

File No. 200100001033 Fee \$ 216.00

By: *Down B. Beach*
Hocking County Recorder

DATE OF LAST REVISION: 2-15-2001

STATE OF OHIO
HOCKING COUNTY
FALLS TOWNSHIP
CITY OF LOGAN

SUBDIVISION PLAT
BRIGHT-OHIO, L.P.

Freeland
SURVEYORS & ENGINEERS

FREE AND ASSOCIATES, INC.
323 WEST STONE AVE.
GREENVILLE, S.C. 29601
TEL: (864) 271-4924 FAX: (864) 271-0315
EMAIL: freeland@wattatt.net

1" = 100'

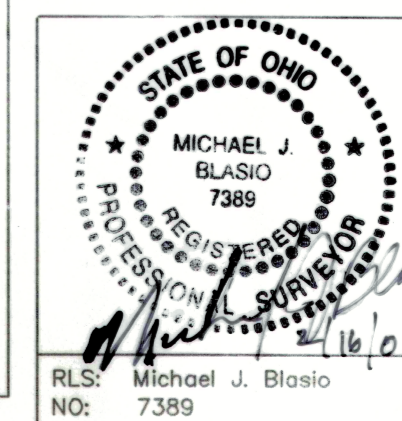

Michael J. Blasio
7389

| | | | |
|-----------------|-------------------------------|------------|------|
| R. LAT | | | |
| R. EED | 0P61-62, 0R105-901, 0R107-39' | | |
| T. A. | 07W-114N-SEC10 - FRAC. LOT 1 | | |
| D. A. OF S. VEY | 3-25-00 | | |
| DRAWN BY | J.P. BEC | | |
| PAR. CHIEF | J.C.C. MVA | 42181-SUB1 | |
| CHECKED BY | MVA | | OF 5 |