

Being a PART of the tract of land that is now or formerly in the name of E & D Assets, Ltd., as recorded in Official Record 247 at page 768, Hocking County Recorder's Office, said tract being situated in Section 9, T14N, R17W, The City of Logan, Falls Township, Hocking County, State of Ohio, and being more particularly described as follows:

Beginning for reference at a 5/8" iron pin found on the Southwest corner of Fractional Lot 5 in Section 9, T14N, R17W;

Thence along the South line of Section 9, North 89 degrees 48 minutes 01 second East a distance of 336.90 feet to a point;

Thence leaving the South line of Section 9, North 00 degrees 11 minutes 59 seconds West a distance of 258.43 feet to a point in the center of Lake Logan Road;

Thence leaving the center of said road, along the Grantor's West line and The City of Logan Corporation line, North 00 degrees 36 minutes 30 seconds East a distance of 29.14 feet to a 2 3/8" x 3 1/2" Berntsen #A2BR30 Break-Off Monument with a 3 1/4" aluminum cap stamped "Seymour & Associates-6044" set and the principle place of beginning;

Thence North 00 degrees 36 minutes 30 seconds East a distance of 1295.93 feet to a 2 3/8" x 3 1/2" Berntsen #A2BR30 Break-Off Monument with a 3 1/4" aluminum cap stamped "Seymour & Associates-6044" set;

Thence South 89 degrees 23 minutes 30 seconds East a distance of 120.57' to a 5/8" x 30" iron pin with a 1 1/4" plastic identification cap stamped "Seymour & Associates" set on the right-of-way of US State Route 33;

Thence continuing along The City of Logan Corporation line, and the Southerly limited access and right-of-way line of U.S. Route 33, the following two courses:

1. South 56 degrees 00 minutes 56 seconds East a distance of 21.32 feet to a 5/8" x 30" iron pin with a 1 1/4" plastic identification cap stamped "Seymour & Associates" set, and;
2. South 45 degrees 39 minutes 34 seconds East a distance of 272.90 feet to a 2 3/8" x 3 1/2" Berntsen #A2BR30 Break-Off Monument with a 3 1/4" aluminum cap stamped "Seymour & Associates-6044" set on the North corner of Lot 2 in Milestone Point Development Phase Two.

Thence leaving The City of Logan Corporation line, the right-of-way line of U.S. Route 33 and along the North line of Lot 2 in Phase Two, the following two courses:

1. South 44 degrees 20 minutes 26 seconds West a distance of 99.25 feet to a 5/8" x 30" iron pin with a 1 1/4" plastic identification cap stamped "Seymour & Associates" set, and;
2. South 05 degrees 32 minutes 19 seconds West a distance of 200.00 feet to a 5/8" x 30" iron pin with a 1 1/4" plastic identification cap stamped "Seymour & Associates" set on the right-of-way line of Grey Street;

Thence along the right-of-way of Grey Street, the following seven courses:

1. With a curve to the left, having a radius of 60.00 feet, the delta being 175 degrees 59 minutes 04 seconds the length of curve being 184.29 feet and the chord bearing South 07 degrees 32 minutes 47 seconds West a distance of 119.93 feet to a 5/8" x 30" iron pin with a 1 1/4" plastic identification cap stamped "Seymour & Associates" set;
2. With a curve to the right, having a delta of 49 degrees 40 minutes 47 seconds, the length of curve being 21.68 feet, a radius of 25.00 feet and the chord bearing South 55 degrees 36 minutes 21 seconds East a distance of 21.00 feet to a 5/8" x 30" iron pin with a 1 1/4" plastic identification cap stamped "Seymour & Associates" set;
3. South 30 degrees 45 minutes 58 seconds East a distance of 124.83 feet to a 5/8" x 30" iron pin with a 1 1/4" plastic identification cap stamped "Seymour & Associates" set;
4. With a curve to the right, having a delta of 16 degrees 08 minutes 26 seconds, a radius of 270.00 feet, the length of curve being 76.06 feet and the chord bearing South 22 degrees 41 minutes 45 seconds East a distance of 73.81 feet to a 5/8" x 30" iron pin with a 1 1/4" plastic identification cap stamped "Seymour & Associates" set;
5. South 14 degrees 37 minutes 32 seconds East a distance of 229.52 feet to a 5/8" x 30" iron pin with a 1 1/4" plastic identification cap stamped "Seymour & Associates" set;
6. With a curve to the right, having a delta 18 degrees 06 minutes 00 seconds, the radius being 470.00 feet, the length of curve being 148.47 feet and the chord bearing South 05 degrees 34 minutes 32 seconds East a distance of 147.86 feet to a 5/8" x 30" iron pin with a 1 1/4" plastic identification cap stamped "Seymour & Associates" set, and;
7. With a curve to the right, having a delta of 96 degrees 43 minutes 33 seconds, the radius being 20.00 feet, the length of curve being 37.76 feet and the chord bearing South 14 degrees 50 minutes 14 seconds West a distance of 29.89 feet to a 5/8" x 30" iron pin with a 1 1/4" plastic identification cap stamped "Seymour & Associates" set on the right-of-way line of Redrock Court;

Thence along the right-of-way line of Redrock Court, the following seven courses:

1. North 79 degrees 48 minutes 00 seconds West a distance of 46.91 feet to a 5/8" x 30" iron pin with a 1 1/4" plastic identification cap stamped "Seymour & Associates" set;
2. With a curve to the right, having a delta of 14 degrees 40 minutes 36 seconds, the radius being 285.00 feet, the length of curve being 73.01 feet and the chord bearing North 72 degrees 27 minutes 42 seconds West a distance of 72.81 feet to a 5/8" x 30" iron pin with a 1 1/4" plastic identification cap stamped "Seymour & Associates" set;
3. With a curve to the right, having a delta of 55 degrees 04 minutes 57 seconds, the radius being 25.00 feet, the length of curve being 24.03 feet and the chord bearing North 37 degrees 34 minutes 55 seconds West a distance of 23.12 feet to a 5/8" x 30" iron pin with a 1 1/4" plastic identification cap stamped "Seymour & Associates" set;
4. With a curve to the left, having a delta of 279 degrees 02 minutes 11 seconds, the radius being 60.00 feet, the length of curve being 292.20 feet and the chord bearing South 30 degrees 26 minutes 28 seconds West a distance of 71.90 feet to a 5/8" x 30" iron pin with a 1 1/4" plastic identification cap stamped "Seymour & Associates" set;
5. With a curve to the right, having a delta of 45 degrees 36 minutes 40 seconds, the radius being 25.00 feet, the length of curve being 19.90 feet and the chord bearing South 86 degrees 16 minutes 17 seconds East a distance of 19.38 feet to a 5/8" x 30" iron pin with a 1 1/4" plastic identification cap stamped "Seymour & Associates" set;
6. With a curve to the left, having a delta of 16 degrees 20 minutes 03 seconds, the radius being 345.00 feet, the length of curve being 98.35 feet and the chord bearing South 71 degrees 37 minutes 39 seconds East a distance of 98.02 feet to a 5/8" x 30" iron pin with a 1 1/4" plastic identification cap stamped "Seymour & Associates" set, and;
7. South 79 degrees 48 minutes 00 seconds East a distance of 32.43 feet to a 5/8" x 30" iron pin with a 1 1/4" plastic identification cap stamped "Seymour & Associates" set;

Thence along the right-of-way line of Grey Street, the following four courses:

1. With a curve to the right, having a delta of 96 degrees 14 minutes 32 seconds, the radius being 20.00 feet, the length of curve being 33.59 feet and the chord bearing South 13 degrees 40 minutes 44 seconds East a distance of 29.78 feet to a 5/8" x 30" iron pin with a 1 1/4" plastic identification cap stamped "Seymour & Associates" set;
2. With a curve to the right, having a delta of 13 degrees 50 minutes 37 seconds, the radius being 455.00 feet, the length of curve being 109.94 feet and the chord bearing South 23 degrees 21 minutes 50 seconds West a distance of 109.67 feet to a 5/8" x 30" iron pin with a 1 1/4" plastic identification cap stamped "Seymour & Associates" set;
3. South 30 degrees 17 minutes 09 seconds West a distance of 109.18 feet to a 5/8" x 30" iron pin with a 1 1/4" plastic identification cap stamped "Seymour & Associates" set;
4. With a curve to the right, having a delta of 91 degrees 15 minutes 04 seconds, the radius being 25.00 feet, the length of curve being 39.82 feet and the chord bearing South 75 degrees 54 minutes 41 seconds West a distance of 35.74 feet to a 5/8" x 30" iron pin with a 1 1/4" plastic identification cap stamped "Seymour & Associates" set on the North right-of-way line of Lake Logan Road;

Thence along the right-of-way line of Lake Logan Road, North 58 degrees 27 minutes 47 seconds West a distance of 304.33 feet to the point of beginning containing 9.3461 acres, more or less, and subject to all easements of record.

The bearings are based on monumentation found on the south line of Section 9 as bearing North 89 degrees 48 minutes 01 second East and are for determining angles only.

This description was prepared from an actual field survey by George F. Seymour, Professional Surveyor No. 6044 in November, 2003 and March, 2006.

The undersigned, E & D Assets LTD., Box 558, Sugar Grove, Ohio 43155 hereby certify that the attached plat correctly represents Milestone Point Development and do hereby accept this plat of same and dedicate to public use all roads and utilities shown hereon and not heretofore dedicated.

IN WITNESS WHEREOF, E & D Assets LTD. hereunto caused this acknowledgment to be executed this _____ day of _____, 2006.

Signed and acknowledged in the presence of:
 Owner: Eric B. Miller
 Witness: Shelly Eggleston
 Printed Name: Shelly Eggleston
 Owner: _____
 Witness: _____
 Printed Name: CLARK D. BERRY

Before me, George F. Seymour a Notary Public, in and for said County and State, personally came _____ ERIC MILLER who acknowledged the signing of the foregoing instrument to be his voluntary act and deed.

IN WITNESS WHEREOF, I have hereunto set my hand and affixed my seal this 30 day of MARCH, 2006.

Notary Public: George F. Seymour, Hocking County

MILESTONE POINT DEVELOPMENT Phase Three

Situated in the City of Logan, Section 9, T-14-N, R-17-W, Falls Township, Hocking County, Ohio

Surveyor's Certification

I certify that all permanent markers and monuments called for have been or will be set upon completion of site work.

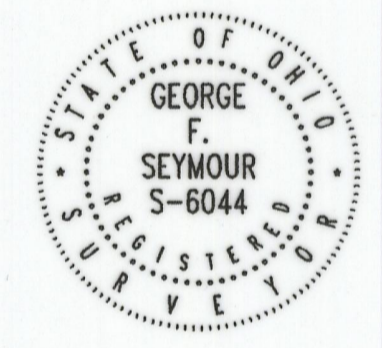

George F. Seymour, P.S.
 Registered Surveyor No. 6044

NOTES:

- 1.) This property is zoned B-2.
- 2.) Reserves A and B are for signage as per annexation resolution.
- 3.) Reserve A has been reconfigured and reduced in size on Phase 2 plat.
- 4.) Development Restrictions Recorded in O.R.240, pages 153-173
- 5.) Public Water & Sewer & Utilities Available

REFERENCES:

County tax maps
 Deeds as noted
 Previous surveys

REFERENCE BEARING:

Bearings derived from monumentation found on the South line of Section 9 as bearing North 89 degrees 48 minutes 01 seconds East and are for the determination of angles only.

| No. | Delta | R= | Bearing | CH= | L= |
|-----|------------|--------|-------------|--------|--------|
| 1 | 19°05'48" | 530.00 | N05°04'38"W | 175.83 | 176.65 |
| 2 | 19°03'56" | 330.00 | N22°09'30"W | 86.52 | 86.77 |
| 2A | 01°04'30" | 330.00 | N30°13'43"W | 6.19 | 6.19 |
| 3 | 49°40'47" | 25.00 | N05°55'34"W | 21.00 | 21.68 |
| 4 | 175°59'04" | 60.00 | S07°32'47"W | 119.93 | 184.29 |
| 4A | 103°22'31" | 60.00 | N32°46'26"W | 94.16 | 108.25 |
| 5 | 49°40'47" | 25.00 | S55°36'21"E | 21.00 | 21.68 |
| 6 | 16°08'26" | 270.00 | S22°41'45"E | 75.81 | 76.06 |
| 7 | 18°06'00" | 470.00 | S05°34'32"E | 147.86 | 148.47 |
| 8 | 96°43'33" | 20.00 | S51°50'14"W | 29.89 | 33.76 |
| 9 | 14°40'36" | 285.00 | N72°27'42"W | 72.81 | 73.01 |
| 10 | 55°04'57" | 25.00 | N37°34'55"W | 23.12 | 24.03 |
| 11 | 131°08'27" | 60.00 | S43°28'54"E | 109.26 | 137.35 |
| 11A | 79°04'50" | 60.00 | S61°37'14"W | 76.39 | 82.81 |
| 11B | 68°47'53" | 60.00 | N44°26'23"W | 67.79 | 72.04 |
| 12 | 45°36'40" | 20.00 | S86°16'17"E | 19.38 | 19.90 |
| 13 | 16°20'03" | 345.00 | S71°37'59"E | 98.02 | 98.35 |
| 14 | 96°14'32" | 20.00 | S31°40'44"E | 29.78 | 33.59 |
| 15 | 135°03'37" | 455.00 | S23°21'50"W | 109.67 | 109.94 |
| 16 | 91°15'04" | 25.00 | S75°54'41"W | 35.74 | 39.82 |
| 17 | 97°44'50" | 25.00 | N18°35'16"W | 37.66 | 42.65 |
| 18 | 25°48'54" | 530.00 | N17°22'42"E | 236.78 | 238.79 |
| 19 | 08°59'54" | 458.00 | N62°57'44"W | 71.86 | 71.93 |

LEGEND

- Point
- 5/8" iron pin found
- ▲ 5/8" x 30" iron pin with 1-1/4" plastic ID cap stamped SEYMOUR & ASSOC. set
- 2-3/8" x 33-1/2" Berntsen #A2BR30 break-off monument with 3-1/4" aluminum cap stamped SEYMOUR & ASSOC. - 6044 set
- 1" OD iron pipe found
- Wood corner post found
- State of Ohio centerline monument in concrete found
- Road Right-of-Way line
- Section line
- Building setback line
- City of Logan Corporation Line
- Utility Easement

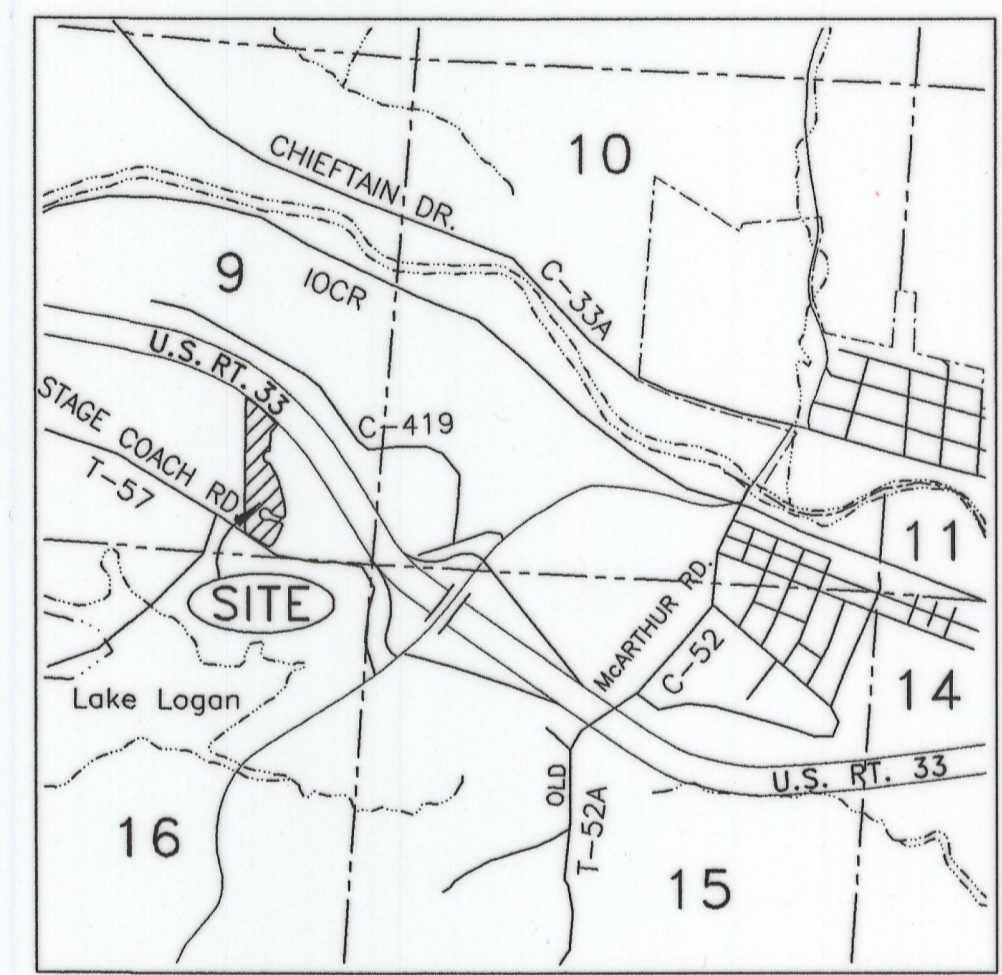

Scale: 1" = 2000'

APPROVALS

Mathematically approved this 30 day of March, 2006.
 Charles Worthington
 Hocking County Engineer's Office

REGIONAL PLANNING OFFICE APPROVAL

This plat approved by the Hocking County Regional Planning Office this 30 day of March, 2006.
 D. E. W. J. P.

CERTIFICATE OF PLANNING COMMISSION

We, the Planning Commission of the City of Logan, Ohio, hereby certify that at a meeting of the Commission held on the _____ day of _____, 2006, a resolution was duly passed approving this plat.
 Michael J. Walsh
 Chairman, Logan City Planning Commission

COUNTY HEALTH DEPARTMENT APPROVAL

This plat approved by the Board of Health, Hocking County, Ohio this 30 day of March, 2006.

BOARD OF HEALTH, HOCKING COUNTY, OHIO

W. J. H. R. S.

AUDITOR'S CERTIFICATE

Transferred on tax duplicate this 30 day of MARCH, 2006.
 Kenneth R. Wilson
 Hocking County Auditor

RECORDER'S CERTIFICATE

Filed for record this 30 day of MARCH, 2006 at 2:14 P.M.
 Recorded this 30 day of MARCH, 2006 in Plat Cabinet 2 at Page 137.
 Wanda K. Becklund
 Hocking County Recorder

200600001526
 Filed for Record in
 HOCKING COUNTY, OHIO
 SANDRA K. LEACH-HUNT
 03-30-2006 At 02:49 PM.
 PLAT 86.40
 OR Book 2 Page 137 - 137

PLAT OF SUBDIVISION

Seymour & Associates
 480 West Harbor Street
 Logan, Ohio 43138
 740-382-4599
 FAX: 740-382-4594
 P.O. BOX 6044
 SEYMOUR & ASSOCIATES
 SURVEYING & ENGINEERING
 email: seymour@hocking.net

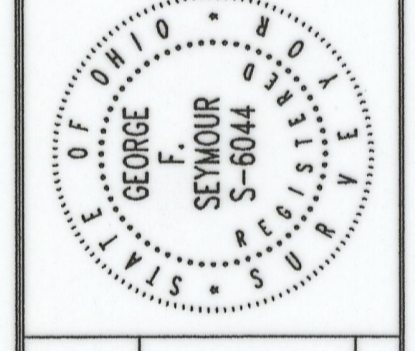

| NO. | DATE | DESCRIPTION |
|-----|------|-------------|
| | | |
| | | |
| | | |
| | | |

SHEET 1/1