

# Plan of Murray City

Plat 1125<sup>l</sup> = 56.95  
Record =  $\frac{53}{57.50}$

In the Original plat the Lots numbered 567 to 716 inclusive, are by mistake numbered from 557 to 706 inclusive, thus having on the original plat, two lots bearing each of the following numbers, viz: 557, 558, 559, 560, 561, 562, 563, 564, 565, 566.

A. H. Wilson Transcriber  
Jacob Weaver, Recorder  
H. C. O.

Scale 3 Ch to an inch.

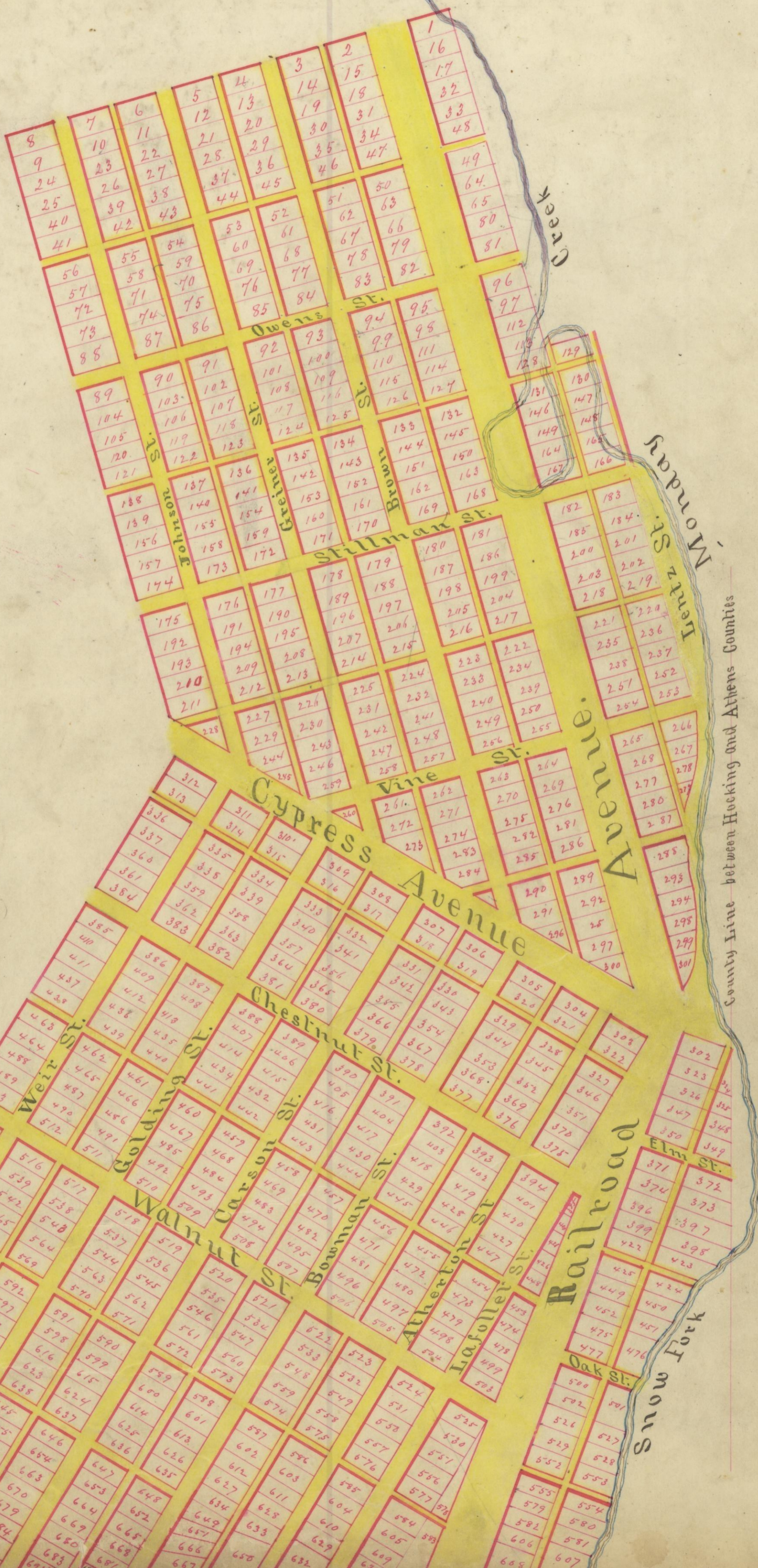

County Line between Hocking and Athens Counties

69