

Plan of the Town of New Castle

I hereby certify that I laid out for Morgan Maxwell and Dennis Wilson Proprietors of the Town of New Castle situate in the N.W. Qr. of Section No. 1 T. 13 R. 16. Hamilton County Ohio all the lots from No. 1 to 32 inclusive with their length and breadth written in links on the following plat. All the lots except fractions 1 and 32 are one hundred links in front and 200 links back. Fraction 1 is 69 links in front and the back end is 15 links. Fraction 32 is 100 links in front and the back end is 154 links main street is 90 links wide and runs N. 15° E. and S. 15° W. Center Street is 75 links wide and runs S 75° E. & N. 75° W. The 11 alleys in the interior are 25 links each in width. The alley around the town is 25 links wide. The stone from which subsequent survey are to be made is planted at the S. E. corner of lot No. 24. There are also stones planted at the N.W. & N.E. corners of fraction 32. and at the N.E. & N.W. corners of fraction 1.

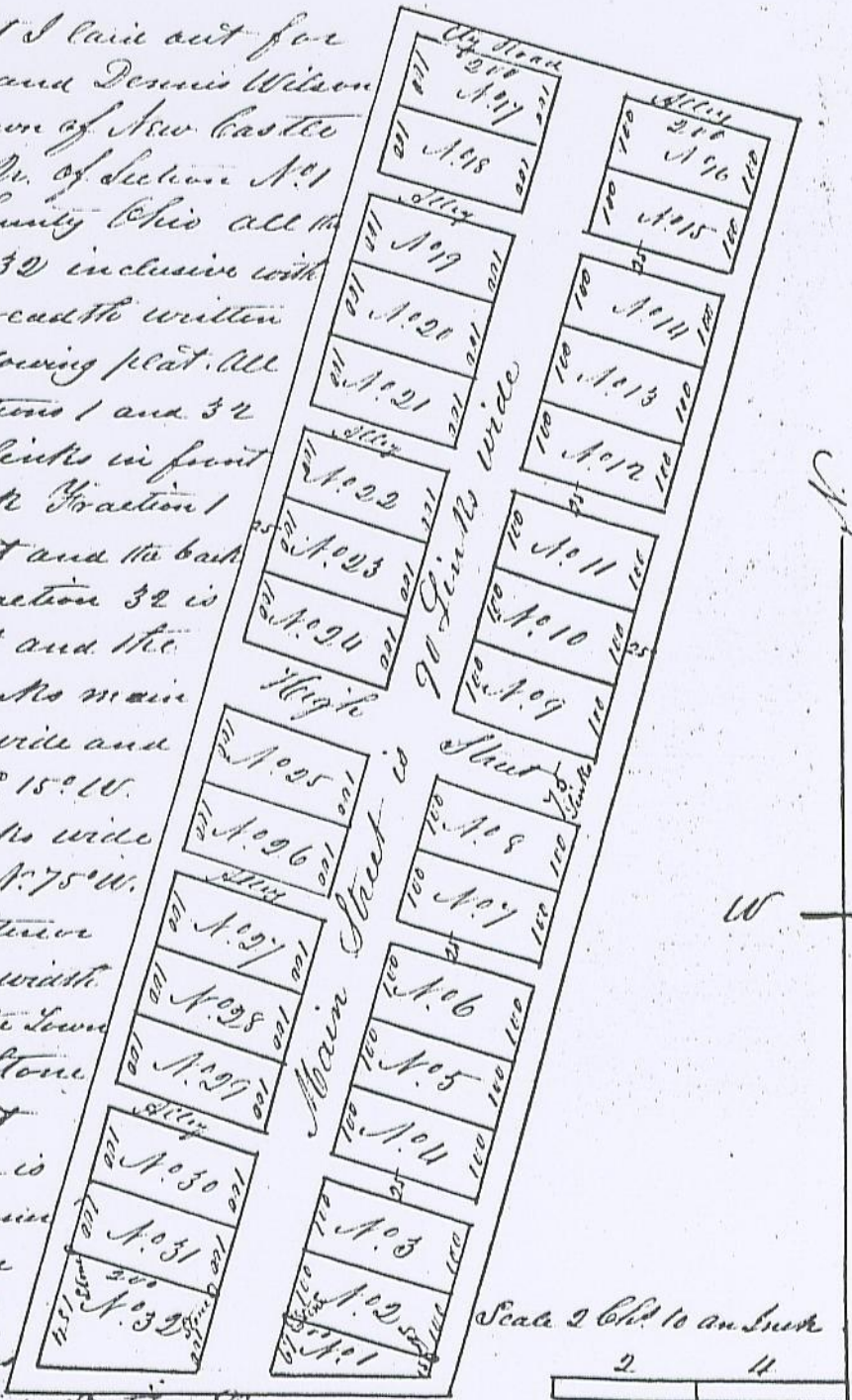

Levi Davis Surveyor of Hamilton County Ohio

