

THIS IMPROVEMENT HAS BEEN DECLARED A LIMITED ACCESS HIGHWAY FROM STATION 19+60 TO STATION 225+00 BY ACTION OF THE DIRECTOR OF HIGHWAYS AND RECORDED IN VOLUME 47 PAGE 340 OF THE DIRECTORS JOURNAL PURSUANT TO LAW.

STATIONS AND OFFSETS WITHIN THE LIMITS OF CENTER LINE SURVEY SPIRALS ARE REFERENCED TO THE SPIRAL TANGENTS.

# CENTER LINE SURVEY PLAT

## LOGAN - LANCASTER ROAD

### U.S. ROUTE 33 SEC. 0.09-0.24

### HOCKING COUNTY, OHIO

### GOOD HOPE TWP. R. 18, T. 13, SEC. 15

Received Jan 4 1963  
 Recorded Jan 4 1963  
 at 11:59 AM.  
 Book C Page 58  
*Esther Carpenter*  
 County Recorder

CENTER LINE PLAT  
 HOC - 33 - 0.09 - 0.24

372

I HEREBY CERTIFY THAT THIS PLAT IS A TRUE DELINEATION OF A SURVEY MADE FOR THE OHIO DEPARTMENT OF HIGHWAYS IN 1962 BY Louis Berger & Associates Orange, New Jersey

SIGNED Henry O. Schimmel  
 REGISTERED SURVEYOR  
 REGISTRATION No. 1183

DATE December 12 - 1962

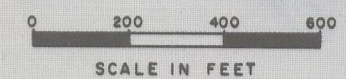

**E SURVEY CURVE DATA**

PI.	39+11.35
Δ	13°-14'
D	2°-30'
Ls	400.00'
Ts	466.16'
Φs	5°-00'
Lc	129.38'
Lt	266.77'
St	133.43'

**E SURVEY CURVE DATA**

PI.	61+04.03
Δ	42°-33'-15"
D	2°-30'
Ls	400.00'
Ts	1093.57'
Φs	5°-00'
Lc	1302.17'
Lt	266.77'
St	133.43'

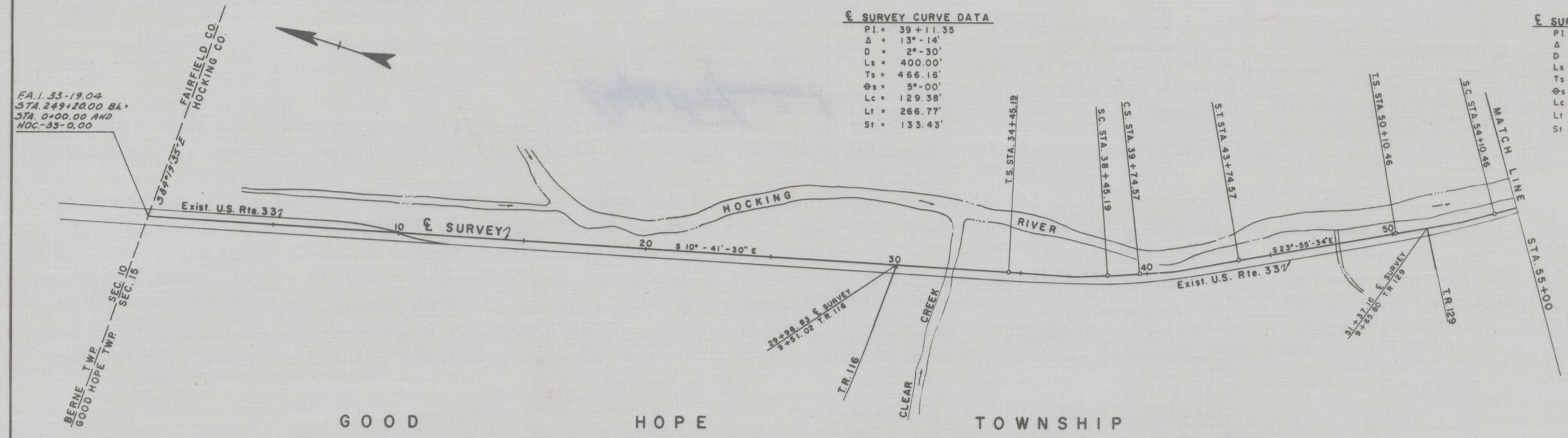

REFERENCE MONUMENTS WILL BE SET ON THE CENTERLINE AT THE FOLLOWING STATIONS AFTER CONSTRUCTION

P.O.T. 4+00	P.O.T. 25+00	C.S. 39+74.57
P.O.T. 10+00	P.O.T. 29+00	S.T. 43+74.57
P.O.T. 15+00	T.S. 34+45.19	T.S. 50+10.46
P.O.T. 20+00	S.C. 38+45.19	S.C. 54+10.46

1