

# Assessment of Land in \_\_\_\_\_ Township, Hocking County, for 1859.

Plat of Section No. 35

NAMES OF OWNERS.

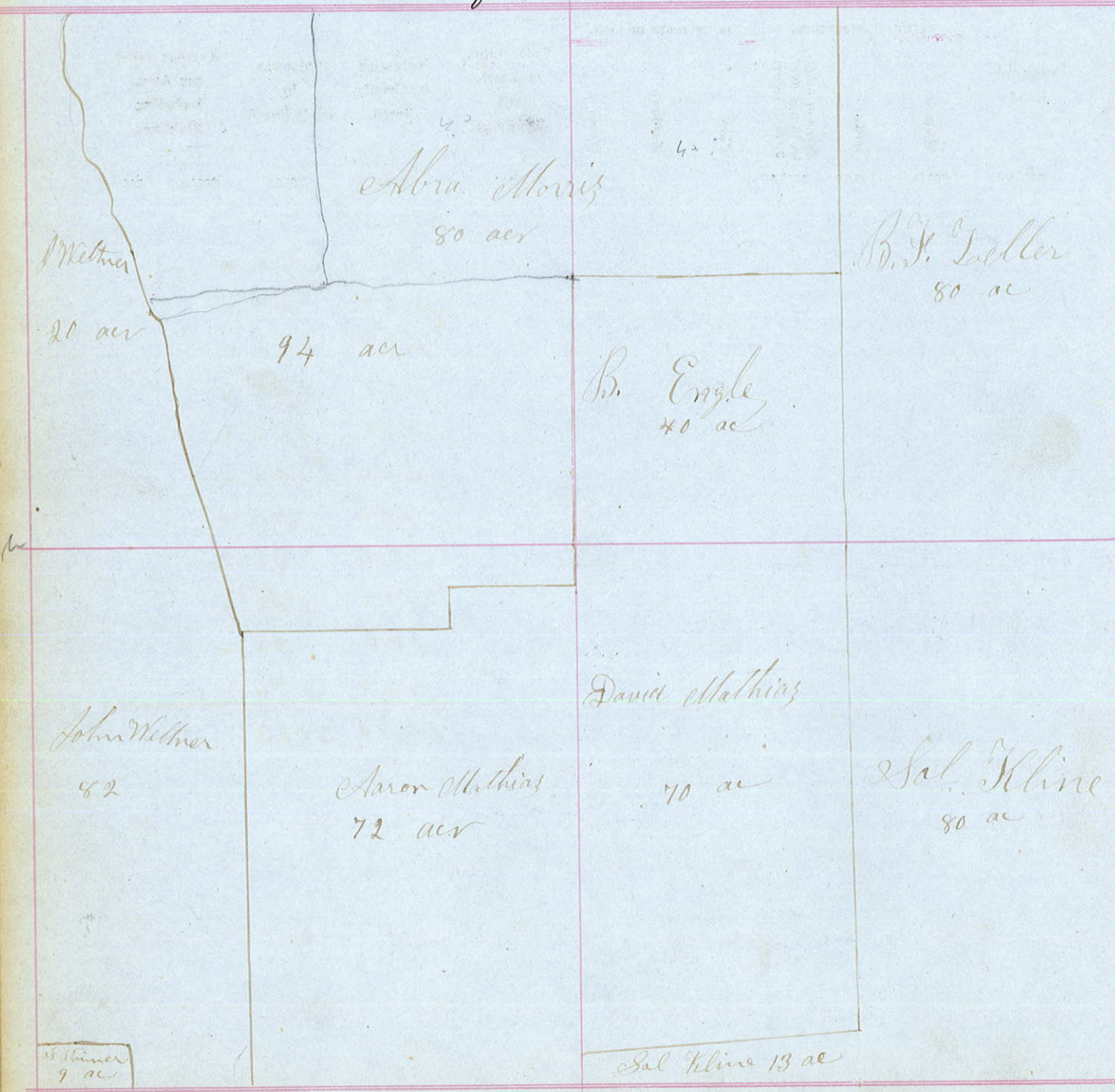

Engle Barnhart  
 Kline Solomon  
 Same  
 Matthias Aaron  
 Matthias David  
 Morris Abraham  
 Same  
 E. Primmer Susan  
 Wiltner John  
 Same  
 Zaeller Benj. H.