

T & D Properties, Ltd.  
Tot. 84.00 Ac.

33.00 Ac.  
SE SE Pt.  
150004710000

58.00 Ac.  
SW SW  
150004920000

39.75 Ac.  
SE SW  
150004810000

William, Randall &  
Donna Hart  
OR192-107  
25.04 Ac.  
SW SE Pt.  
150004890000

lot. /6.68 Ac.  
150004880000

123-751  
42.00 Ac.  
SE SW

176-512  
35.00 Ac.  
S 1/2 SE Pt.

44.00 Ac.  
NE NE

20.00 Ac.  
N 1/2 NW NW  
150000810000

Michael &  
Carol Hunter  
OR56-426  
Tot. 89.75 Ac.

William, Randall & Donna Hart  
OR192-107, 4.20 Ac.  
150000760100

Dale Smith  
OR150-720  
10.00 Ac.  
NW NE Pt.  
150000760200

Christina Binkley  
OR269-991  
Tot. 8.82 Ac.  
150000760000

Larry &  
Melody Smallwood  
OR164-553  
150000760300

59.90 Ac.  
NE Pt.

Michael & Patricia Butler  
196-888  
Tot. 126.50 Ac.  
150000760300

The Mead Corp.  
Tot. Sec. 252.50 Ac.  
106-205  
81.00 Ac.  
N 1/2 NW  
150000510000

N 1/2 NW Pt.  
69.75 Ac.  
N 1/2 NW Pt.,  
Frac. 4 Pt.  
150000790000

Geneva Young  
98-151  
Tot. 84.00 Ac.  
150000970000

40.00 Ac.  
SE NE

82.00 Ac.  
SW NW, NW SW

37.29 Ac. \*  
Frac.5 Pt.

Richard Smith  
OR36-517  
3.44 Ac.  
150000730100

69.60 Ac.  
NE Pt.

Ronald Jenne  
171-666  
81.00 Ac.  
S 1/2 NW  
150000470000

Jack &  
Vicki Vanover  
OR41-868  
Tot. 46.00 Ac.  
150000950000

37.00 Ac.  
NE SE

Emmet & Ellen  
Smith  
140-351  
Tot. 142.17 Ac.  
150000730000

22.88 Ac. \*  
NE SW Pt.

Steve & D. Lynn  
Smith  
OR272-351  
12.20 Ac.  
150000730200

41.00 Ac.  
NW SE

The Mead Corp.  
106-205  
Tot. 82.00 Ac.  
150000780000

40.50 Ac.  
NE SW

Phillip &  
Stephen Buckley  
222-590  
Tot. 4.06 Ac.  
150000740000

41.00 Ac.  
NE SE

The Mead Corp.  
Tot. Sec. 252.50 Ac.

Marlene & Norman  
Thompson  
205-437, 120-88  
Tot. 43.00 Ac.  
150000940000

9.00 Ac.  
SE SE Pt.

Jack Bentley  
Tot. 110.50 Ac.  
150000720100

Kelly Route  
OR199-243  
4.15 Ac.  
150000720200

Kenneth Route  
207-66  
3.44 Ac.  
150000720000

Yolanda  
Route-Werner  
OR199-245  
4.15 Ac.  
150000720300

N 1/2 SE SW Pt.

OR19-700  
40.00 Ac.  
SW SE

Richard & Barbara  
Harwood  
OR304-797  
40.88 Ac.  
SE SE  
150000800000

106-205  
81.00 Ac.  
W 1/2 SW  
150000500000

109-231  
40.50 Ac.  
SE SW  
150000500000

22.00 Ac.  
SE SE Pt.

114-614  
41.00 Ac.  
SW SW

114-614  
3.00 Ac.

OR19-700  
26.50 Ac.  
Frac.1, N 1/2  
SE SW Pts.  
Frac.1 Pt.

OR19-700  
40.00 Ac.  
SW SE

Richard & Barbara  
Harwood  
OR304-797  
40.88 Ac.  
SE SE  
150000800000

109-231  
40.50 Ac.  
SE SW  
150000500000

11.00 Ac.  
SW SE Pt.

22.00 Ac.  
SE SE Pt.

114-614  
41.00 Ac.  
SW SW

114-614  
3.00 Ac.

OR19-700  
26.50 Ac.  
Frac.1, N 1/2  
SE SW Pts.  
Frac.1 Pt.

OR19-700  
40.00 Ac.  
SW SE

Richard & Barbara  
Harwood  
OR304-797  
40.88 Ac.  
SE SE  
150000800000

109-231  
40.50 Ac.  
SE SW  
150000500000

R19W  
R19W

SC05BT  
EAGLE08

SC04BT  
EAGLE09

VINTON COUNTY  
T10N R19W  
T10N R19W

SC04BT  
EAGLE09

SC03BT  
EAGLE10

T10N R19W  
T10N R19W

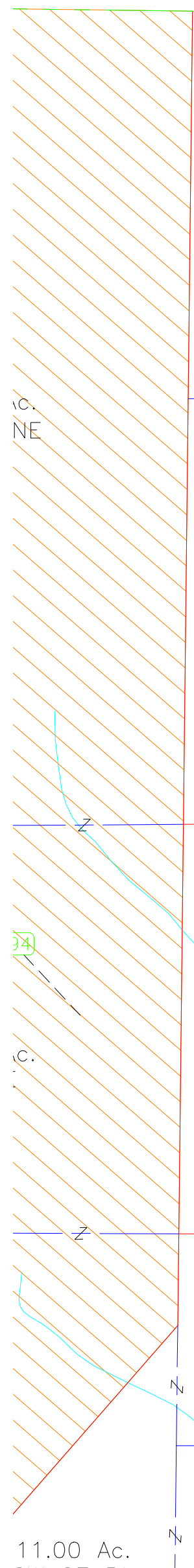

EAST PIKE RUN RD.

EAST PIKE RD.

PIKE RD.

EAST FORK RD.

BLUE CREEK RD.

BLUE CREEK RD.

FORK RD.

SC32 SC33  
SC05BT SC04BT

T11N R19W  
T10N R19W

SC33 SC34  
SC04BT SC03BT

T10N R19W  
T10N R19W

T10N R19W  
T10N R19W

SC05BT  
EAGLE08

SC04BT  
EAGLE09

VINTON COUNTY  
T10N R19W  
T10N R19W

SC04BT  
EAGLE09

SC03BT  
EAGLE10

T10N R19W  
T10N R19W