

HOCKING COUNTY STATE OHIO

SECTION No. 19 TWP. 13 RANGE 16

Original A.W.S. Mar. 23, 1938.

GREEN

NORTH

SCALE: 500 FEET TO 1 INCH

26 20

25

14

13

W. REEVES  
2 Ac.  
Pt Lot 3  
9 AC.  
ELMER MILLER

Lot 2 75 AC.  
W<sup>m</sup> Clark Winder Jr. et al  
Tax Acreage 108 AC.

Marie Sharb  
Pt Lot 1 85 ac.

Joseph Mc Gatha  
Pt Lot 3 20 AC.

Pt Lot 1 5 ac  
T. M<sup>r</sup>. Gathey

E. DOUGHMANN  
1 Ac.

Lot 6 29 AC.  
Marie Sharb

Pt Lot 3 18.48 ac

Lot 4 37 ac.

Lot 5 36 AC  
W<sup>m</sup> Clark Winder Jr. et al  
2 Ac. ← JOHN & REA BOND

Lot 8 32.52 ac.  
Wendell Phillips  
Total Tax 51 ac.

MARGARET  
BARNHART

Lot 9 132.68 ac.  
Paul & Dorothy Thrush  
Tax acreage 132 ac.

Pt Lot 10 40 ac

Pt Lot 10 40 ac

Pt Lot 11 24.82 ac.

Pt Lot 11 17 ac.  
Marg Barnhart

KEITH & MILDRED SCHULTZ

Pt Lot 11-10 ac  
Total Tax Acreage 40 ac

Pt Lot 11 10 ac

EDWIN & MARY KELLEY

Pt Lot 12 8 ac

Pt Lot 12 10.75 ac.

40.24

19.74

20.50

Starr  
30

24 Starr

OK - 8/3/85

SOUTH

GREEN 19

Starr  
18

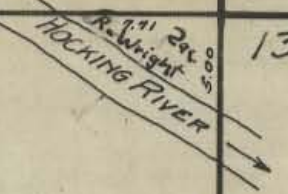

EAST R. WRIGHT (INDEFINITE)

WEST