

HOCKING COUNTY

Sec. 21 T11 R18

BENTON TWP.

Scale: 1" = 200'

21-A

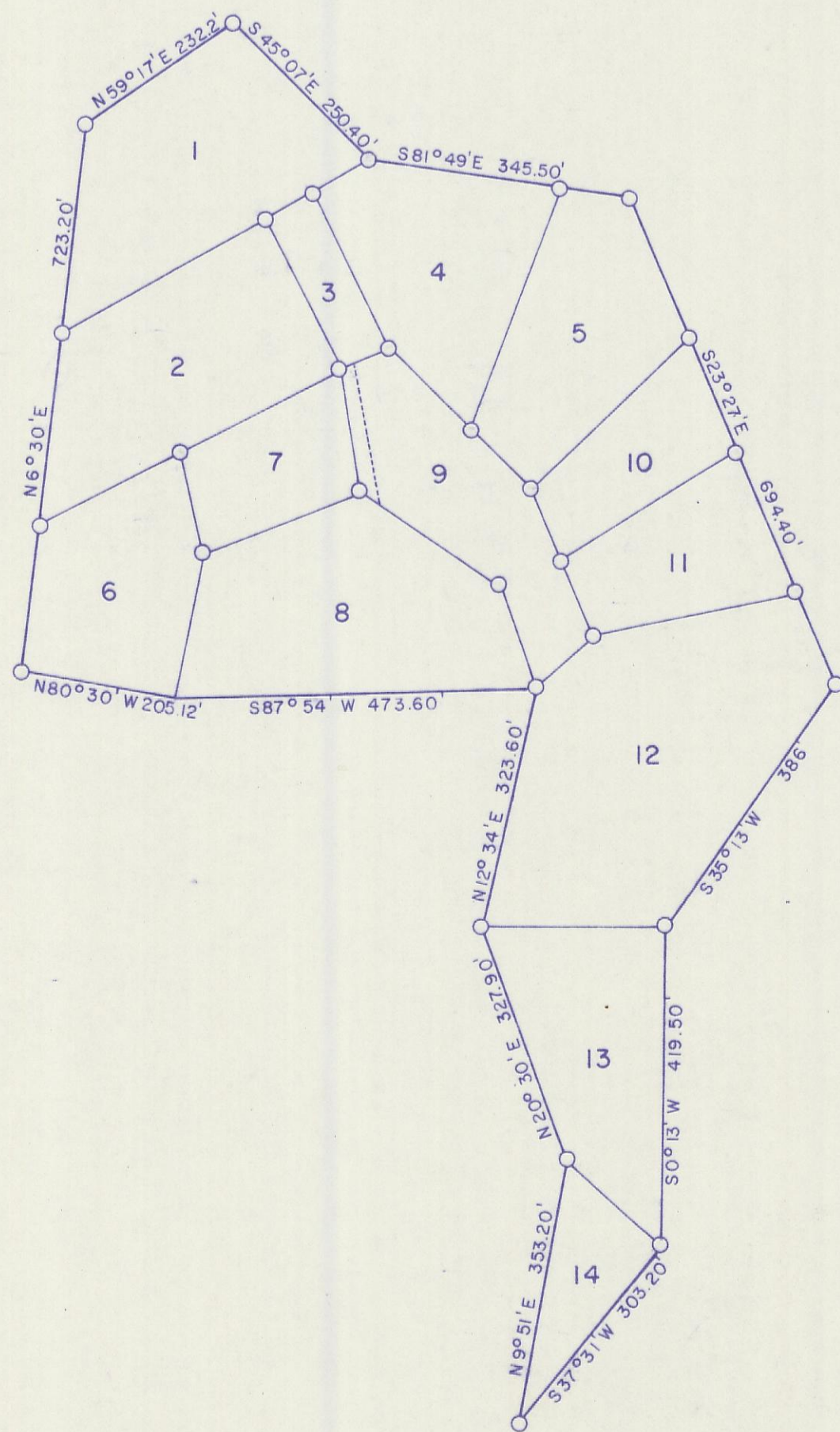
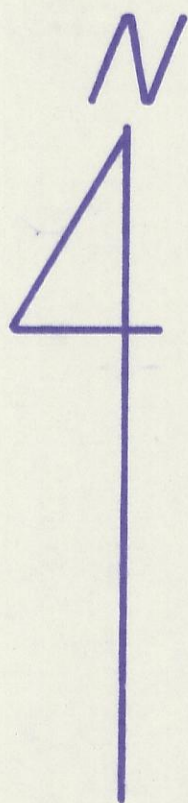

Lot 1	Mitchell B. & Viola Andrye	163-569	1.848 Ac.
Lot 2	" "	" "	1.863 Ac.
Lot 3	Rustic Hills	124-15	.37 Ac.
Lot 4	" "	" "	1.474 Ac.
Lot 5	Michael & J.L. Reardon	161-420	1.445 Ac.
Lot 6	Mary A. Sommer	Not Recd.	1.227 Ac.
Lot 7	Rustic Hills	124-15	.748 Ac.
Lot 8	Glen E. Michel	169-762	2.03 Ac.
Lot 9	" "	" "	1.245 Ac.
Lot 10	Rustic Hills	124-15	.812 Ac.
Lot 11	" "	" "	.966 Ac.
Lot 12	Rustic Hills	124-15	2.99 Ac.
Lot 13	Ralph & Pearl Miller	174-488	1.455 Ac.
Lot 14	Rustic Hills	124-15	.57 Ac.

RUSTIC HILLS NO. 1 21-A