

HOCKING COUNTY

Sec. 2 T13 R16

GREEN TWP.

Scale 1"=400'

Sec. 3

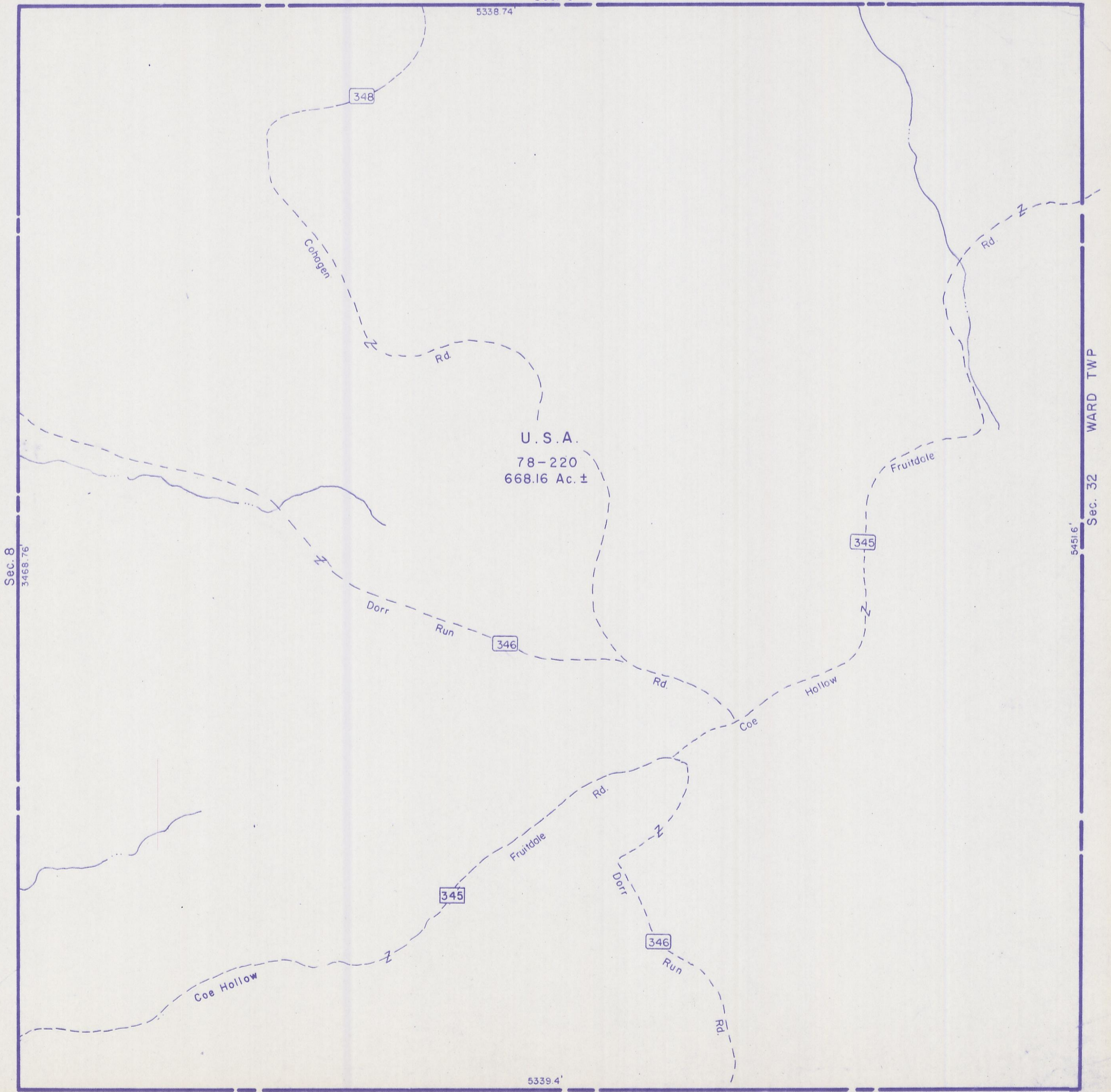

Sec. 8
3468.76'

5338.74'

348

Congen

Rd.

U.S.A.
78-220
668.16 Ac. ±

Dorr

Run

346

Rd.

Hollow

345

Fruitdale

Sec. 32
WARD TWP
5451.6'

345

Fruitdale

Rd.

Coe Hollow

Dorr

346

Run

Rd.

Sec. 1

5339.4'

Sec. 2