

HOCKING COUNTY

FALLS TWP.

Scale 1" = 50'

14-1

14 - F

City of Logan
182-038

3.64 Tot. Ac. Lot 41

O. L. 41

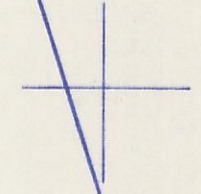

N 72° 30' W

555.0

City of Logan
182-038
5.31 Tot. Ac.
Lot 39

O. L. 39

City of Logan

182-038

2.17 Ac.

Lot 42 pt.

O. L. 42

452.71

State of Ohio
U. S. Route 33
1.11 Ac.
Lot 42 pt.

608.0

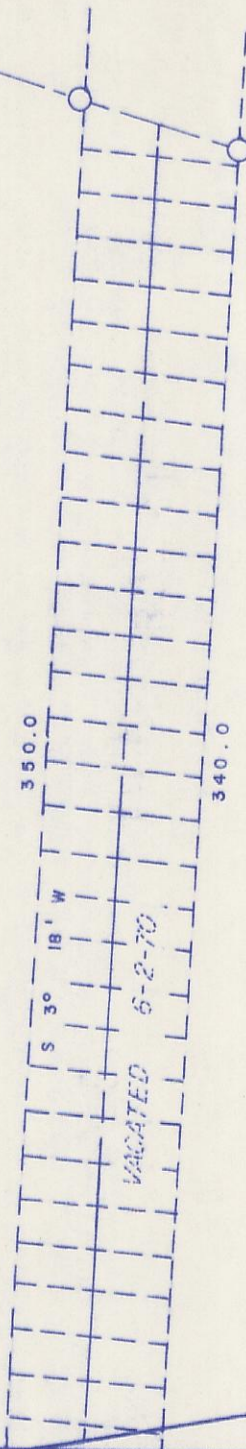

14 - H