

# HOCKING COUNTY

Sec. 21 T11 R18

BENTON TWP.

Scale: 1"=200'

21-A

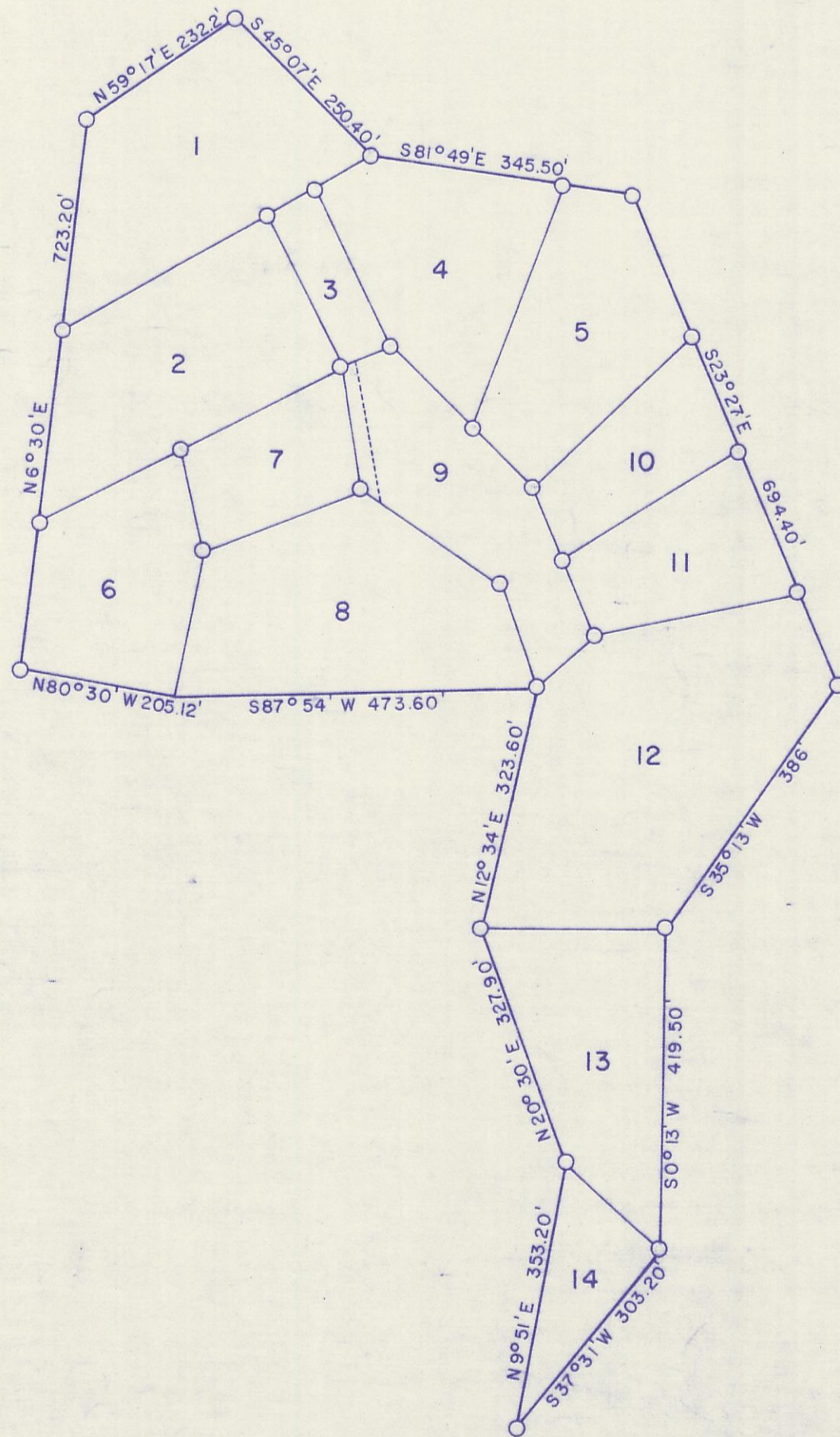
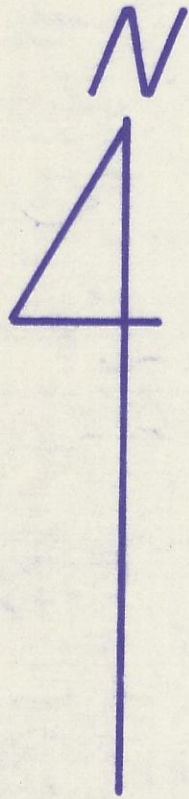

Lot 1	Jane Snyder, Etal	201-909	1.848 Ac.
Lot 2	" " "	" "	1.863 Ac.
Lot 3	Rustic Hills Outdoor Club	211-562	.37 Ac.
Lot 4	Roy & Linda Kean	206-738	1.474 Ac.
Lot 5	Roy & Linda Kean	185-573	1.445 Ac.
Lot 6	Mary A. Sommer	Not Recd.	1.227 Ac.
Lot 7	John & Mary Sommer	206-248	.748 Ac.
Lot 8	Glen E. Michel	169-762	2.03 Ac.
Lot 9	Donna Szuhy	196-12	1.245 Ac.
Lot 10	Roy & Linda Kean	206-738	.812 Ac.
Lot 11	" " "	" "	.966 Ac.
Lot 12	Willard & Mary Burmester	196-636	2.99 Ac.
Lot 13	Edward & Eleanor Vetter	210-830	1.455 Ac.
Lot 14	" " "	" "	.57 Ac.

RUSTIC HILLS NO. 1 21-A